

**The 65<sup>th</sup> Annual Convention of the  
Midwest Modern Language  
Association**

**Chicago, IL**

**14–16 November 2024**



# Table of Contents

<b>The Midwest Modern Language Association</b>	4
<i>Journal of the Midwest Modern Language Association</i>	5
<b>Convention Information</b>	6
<b>Special Events</b>	8
<b>Hilton Chicago Floor Plans</b>	10
<b>Program of Sessions</b>	
Thursday	12
Friday	22
Saturday	44

# The Midwest Modern Language Association

*Organized 1959, Incorporated 1971*

## **Officers and Staff for 2024**

President: Nathan A. Jung, University of Wisconsin–Madison  
Vice President: Joe Keener, Indiana University Kokomo  
Past President: Gaywyn Moore, Santa Clara University  
Executive Director: Jack Kerkering, Loyola University Chicago  
Program Manager: Annette LePique, Loyola University Chicago  
Program Fellow: Krislyn Zhorne, Loyola University Chicago  
Undergraduate Intern: Kate McLaughlin, Loyola University Chicago

## **Executive Committee**

Nathan A. Jung, University of Wisconsin–Madison  
Joe Keener, Indiana University Kokomo  
Gaywyn Moore, Santa Clara University  
Olga Bezhanova, Southern Illinois University–Edwardsville  
Darío Sánchez-González, Gustavus Adolphus College  
Esther Teixeira, Texas Christian University  
Eric Wistrom, United States Naval Academy  
Krislyn Zhorne, Loyola University Chicago

## **Program Committee**

Nathan A. Jung, University of Wisconsin–Madison  
Joe Keener, Indiana University Kokomo  
Darío Sánchez-González, Gustavus Adolphus College  
Esther Teixeira, Texas Christian University

## **MMLA Membership Information**

Members of the MMLA include Institutions (such as libraries), university Departments (such as English or Modern Languages), and Individuals in various academic positions (from graduate students to faculty and administrators). Membership fees are fixed for Institutions (\$70), Departments (\$200), and Graduate Students (\$25), and they are tied to annual salaries Individuals.

Membership in the MMLA is for the fiscal year; persons who join are enrolled as members for the year in which they join from July 1 of the current year until June 30 of the subsequent year. To purchase a membership online please see the MMLA's member portal below.

**Member Portal:** <https://mmla.memberclicks.net/>

**Loyola Website:** [www.luc.edu/mmla](http://www.luc.edu/mmla)

# *Journal of the Midwest Modern Language Association*

## **Editorial Committee**

Gaywyn Moore, Santa Clara University

Olga Bezhanova, Southern Illinois University–Edwardsville

Eric Wistrom, United States Naval Academy

## **Loyola Staff Support**

Book Reviews Editor: Jack Kerkering, Loyola University Chicago

Editorial Fellow: Krislyn Zhorne, Loyola University Chicago

Program Manager: Annette LePique, Loyola University Chicago

## **About the Journal**

The *Journal of the Midwest Modern Language Association (JMMLA)*, formerly the *Bulletin*, is published bi-annually at the Executive Offices of the Midwest Modern Language Association at Loyola University Chicago. Authors of manuscripts and book reviews published in the *JMMLA* must be members of the MMLA. Officers and members of the Executive Committee serve as the Editorial Board.

## **Statement of Editorial Policy**

The *Journal* is published as a service to MMLA members, who are encouraged to submit articles on special topics announced in advance on the member portal and website.

## **Business Inquiries**

All communications including matters concerning address changes, advertising, permissions, and subscriptions should be directed to the Midwest Modern Language Association, Loyola Hall 308, Loyola University Chicago, 1032 West Sheridan Road, Chicago, IL 60660. Phone calls may be made to (773) 508-6083, and emails may be sent to [mmla@luc.edu](mailto:mmla@luc.edu). For more information, please see our member portal.

## **Current Calls for Submissions**

The *JMMLA* invites submissions for a **Spring 2025** special issue on the theme of “Solidarity.” For additional information (including possible topics, submission procedures, and formatting guidelines), please visit our member portal at <https://mmla.memberclicks.net/current-calls-for-submissions>.

**Co-Editors:** Kelly Kidder, Lipscomb University

Brynn Fitzsimmons, University of Alabama

**Submission Deadline:** 15 January 2025

# Convention Information

## **Appropriate Conduct at the MMLA Convention**

The MMLA Convention depends upon all participants (panelists, attendees, staff) conducting themselves in a professional manner. We are committed to ensuring a safe, welcoming, non-discriminatory environment for all participants. Additional details can be found on our member portal at <https://mmla.memberclicks.net/health-safety>.

## **Registration Desk**

The MMLA's Registration Desk will be located on the third floor of the hotel in the Coat Check room and will be open on Thursday, Friday, and Saturday from 9:00 am to 5:00 pm. Staff members will also be rotating throughout the convention site and would be happy to help answer any questions.

Membership and convention fees can be paid online at <https://mmla.memberclicks.net/>. Credit cards, cash, and checks will not be accepted at the Registration Desk.

## **Location of Meeting Rooms**

For all meetings and events, please refer to the locations listed in the third column of the "Programs of Sessions" listed on pages 12–61. Floor plans for the hotel are provided on pages 10–11.

## **Virtual Sessions**

Unlike in years previous, no virtual sessions will be scheduled during the 2024 MMLA Convention.

## **General Panel Structure**

For MMLA's 2024 Convention, panels with four presenters have been scheduled for hour-and-a-half sessions, which allots each panelist up to fifteen minutes to present their work before a thirty-minute, collective Q&A. Panels with three or two presenters are scheduled for hour-and-fifteen-minute sessions, providing each panelist fifteen minutes (or, in the case of the latter, twenty minutes) to present their work before the collective Q&A portion.

## **Professionalizing Sessions**

Presenters will discuss their own experience and what they have found particularly helpful along the way. Sessions are usually an hour and fifteen minutes long, permitting each presenter to speak before addressing questions from the audience for the remainder of the time.

## **Associated Organizations**

Because of shared disciplinary interests, the MMLA annually provides time and meeting space during its convention for panels of organizations referred to in the program as an "Associated Organization." These panels are open to all who are registered for the MMLA Convention and display an identification badge.

### **Child Care**

Please contact the convention site, the Hilton Chicago, who can answer questions about child-care services and locations for nursing.

### **Americans with Disabilities Act**

Every effort will be made to accommodate registrants with ADA-related needs.

### **Future Conventions of the MMLA**

November 2025: *To Be Announced*

12–14 November 2026: voco Chicago Downtown, Chicago, IL

### **Proposing a Pre-Organized Panel for MMLA 2025**

A Pre-Organized Panel is a three- or four-paper presentation coordinated by an organizer and based on a unifying subject, which may or may not be related to the annual convention's theme. While not required, should the organizer be so inclined, a Pre-Organized Panel with three or four papers may include a respondent. The organizer also has the option to include a paper of his/her own on the panel.

The MMLA happily posts subject-specific calls for papers on its member portal to assist organizers in their task. To request that we do so for you, please submit the following materials to [mmla@luc.edu](mailto:mmla@luc.edu) by Friday, March 14, 2025:

- Organizer's Name, Email Address, and Affiliation
- Panel Title (15-word maximum)
- A Call for Papers Announcement

Individual-paper proposals to a Pre-Organized Panel are due to the organizer by his/her imposed deadline but no later than Monday, April 14, 2025. After soliciting, reviewing, and selecting individual proposals, all organizers must submit a Pre-Organized-Panel proposal to the MMLA by the May 01 deadline. The following materials are required for consideration:

- Organizer's Name, Email Address, and Affiliation
- Panel Title (15-word maximum)
- Presenter Names, Email Addresses, and Affiliations
- Paper Titles (15-word maximum each)
- Abstracts (approximately 250 words each)

### **2024 Program Cover**

Designed by Christopher Martiniano, Indiana University-Bloomington

# Special Events

## I. Book Exhibit

Exhibitors: Bridge Art NFP, Gerber/Hart Library and Archives, Punctum Books

Location: Third Floor, Waldorf

Dates/Hours: Thursday, November 14, 9:00 am – 5:00 pm

Friday and Saturday, November 15–16, 8:00 am – 5:00 pm

## II. CV Drop-In Workshop

Advisors: Members of the MMLA Executive Committee

Location: Third Floor, PD 6

Dates: Friday and Saturday, November 15–16

Hours: 10:00 am – 4:00 pm

## III. Professionalizing Sessions

### Friday, November 15

#### 46. **AI Pedagogy Workshop**

Presenter: *Nathan A. Jung*, University of Wisconsin–Madison

Location: Third Floor, PD 7

Time: 11:00 am – 12:15 pm

#### 53. **Getting it Published: Articles**

Presenter: *Olga Bezhanova*, Southern Illinois University–Edwardsville

Location: Third Floor, PD 7

Time: 12:45 pm – 2:15 pm

### Saturday, November 16

#### 96. **Alt Ac Careers – “Beyond a Plan B Framework”**

Presenters: *Gaymyn Moore*, Santa Clara University

*Darío Sánchez-González*, Gustavus Adolphus College

Location: Third Floor, PD 7

Time: 11:00 am – 12:15 pm



### **102. Online Teaching**

Presenters: *Joe Keener*, Indiana University Kokomo

*Eric Wistrom*, United States Naval Academy

Location: Third Floor, PD 7

Time: 12:45 pm – 2:00 pm

## **IV. Keynote Address**

### **74. “On Burning Ground: The Futures of Health in/of the Humanities”**

Speaker: *Dr. Andrea Charise*, University of Toronto-Scarborough

Location: Third Floor, Williford ABC

Date: Friday, November 15

Time: 5:30 pm – 6:30 pm

## **V. President’s Reception**

### **75. President’s Reception**

Celebrate with complimentary hors d’oeuvres and (non)alcoholic drinks!

Location: Third Floor, Williford ABC



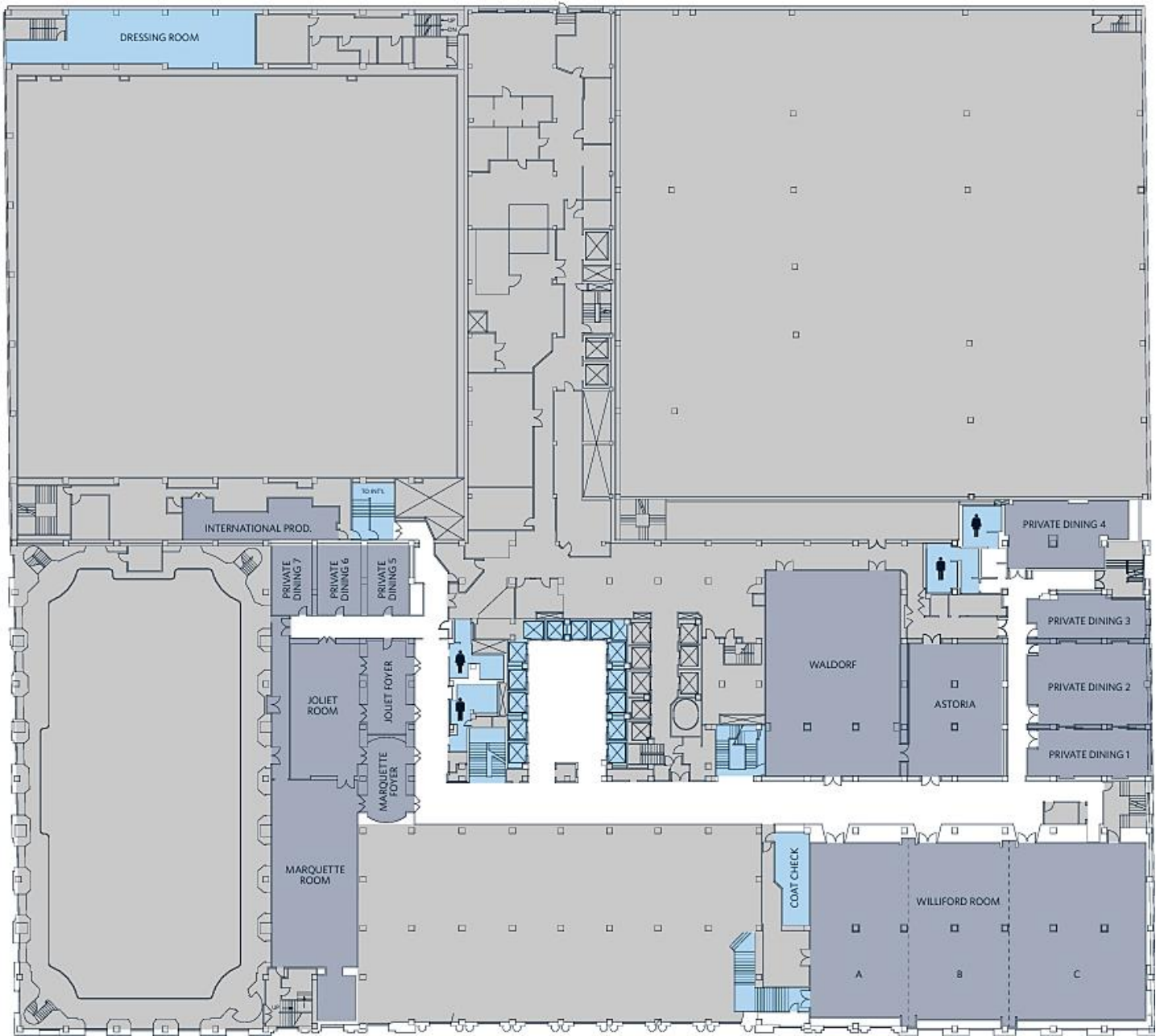

Date: Friday, November 15

Time: 6:30 pm – 7:30 pm

# Hilton Chicago, Third Floor



## KEY

- |  |   |
|--|---|
|  Meeting/Conference Rooms |  Restrooms |
|  Amenities                |  Elevator  |
|  Heart of House           |   |

# Hilton Chicago, Fourth Floor

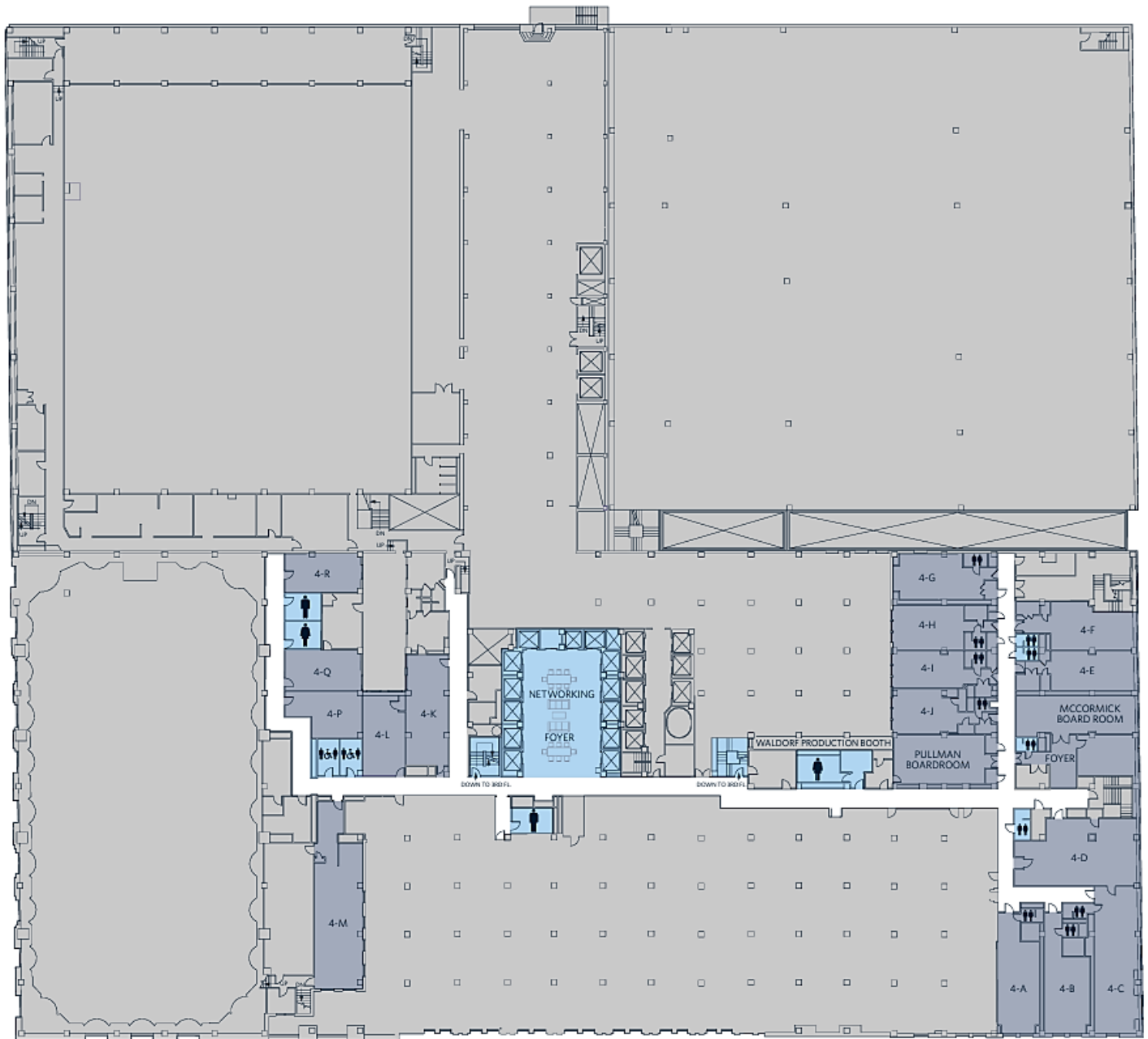

## KEY

- Meeting/Conference Rooms
- Amenities
- Heart of House

- Restrooms
- Elevator

# Program of Sessions

Thursday, November 14

Book Exhibit: 9:00 am – 5:00 pm; Third Floor, Waldorf

---

---

## 1. Fact and Fiction: Autobiographical, Historical, and Speculative Literature in Twentieth-Century Latin America

*Pre-Organized Panel*

Chair: Cristina Esteves-Wolff, University of Chicago

- |          |   |                    |
|----------|---|--------------------|
| 9:30 am  | (a) <b>Fictions of the Self: Reading and Writing in José Vasconcelos' <i>Ulises Criollo</i></b><br><i>Enrique Macari</i> , University of Illinois–Chicago   | <u>Third Floor</u> |
| –        | (b) <b>Aestheticizing the Revolution, from the Caribbean to Europe (and Back Again): Alejo Carpentier's <i>El siglo de las luces</i></b><br><i>Cristina Esteves-Wolff</i> , University of Chicago | PD 1               |
| 10:45 am | (c) <b>Representations of the Amazon in Twentieth-Century Brazilian Science Fiction</b><br><i>Eduardo Leão</i> , University of Chicago  |                    |
- 
- 

## 2. Developing Locally Responsive Health-Oriented Writing Courses to Engage Students in the Humanities

*Pre-Organized Panel*

Chair: Laura L. Beadling, Youngstown State University

- |          |   |                    |
|----------|---|--------------------|
| 9:30 am  | (a) <b>A First-Year Composition Course Grounded in a Health Humanities Perspective</b><br><i>Jay L. Gordon</i> , Youngstown State University  | <u>Third Floor</u> |
| –        | (b) <b>Graphic Medical Humanities in the Classroom: A Course in Graphic Memoirs of Illness and Recovery</b><br><i>Laura L. Beadling</i> , Youngstown State University                   | PD 3               |
| 10:45 am | (c) <b>Research-Driven Strategies for Developing Responsive Healthcare Writing Courses for Different Student Populations</b><br><i>Diana Awad Scrocco</i> , Youngstown State University |                    |
- 
-

---

---

### 3. U.S. Combat and Its Consequences in Two Centuries

Moderator: *To Be Determined*

- 9:30 am (a) **“The Marvellous Thing”: The Unpredictability and Certainty of Death**  
*Rebecca Curry*, Middle Tennessee State University Third Floor
- 
- 10:45 am (b) **Disability, Health, and the “Resilient” Masculine Subject in American Narratives of Combat and Recovery**  
*Will Kanyusik*, Loras College PD 4
- (c) **The Artifice of Memory: The Spoken word as a Social Practice in Abner Benaim’s *Invasión***  
*Manuel Sánchez Cabrera*, University of North Carolina–Chapel Hill
- 
- 

### 4. Twentieth-Century European Dystopias of the Imperial State: Spain and England

*Undergraduate Research Symposium*

Moderator: *To Be Announced*

- 9:30 am (a) **The Toxic Medicine of Colonialism: A Condemnation of the Doctor, a Defense of the Creep**  
*Noah Reese-Clauson*, Loyola University Chicago Third Floor
- 
- 10:45 am (b) **The Violent Symbiosis of Criminals and The State: A Marxist Reading of Burgess’ *A Clockwork Orange***  
*Kassandra Faylun*, University of Central Florida PD 5
- 
- 

### 5. Public Debates, Hispanic Identities: Visions of the Press in Puerto Rico and Arizona, 1882-1930

*Pre-Organized Panel*

Chair: Ana Rodríguez Navas, Loyola University Chicago

- 9:30 am (a) **“La guerra de la intransigencia” The Press and Jesuit Education in Puerto Rico (1882)**  
*Joseph M. Laughlin, SJ*, Loyola University Chicago Fourth Floor
- 
- 10:45 am (b) **¿Mejorando la raza?: Questions of identity in Two Mexican Newspapers in Tucson, AZ**  
*Anthony Erlinger*, Loyola University Chicago Room 4-A
- (c) **“Muchos periódicos:” Readership and the Expansion of. . .**

Thursday, November 14

**the Press in Puerto Rico, 1898–1930**

*Ana Rodríguez Navas*, Loyola University Chicago

---

---

**6. Instability in Physical Existence or Perceptions in Medieval Literary Texts**

*Permanent Section: Old and Middle English Language and Literature*

Chair: Kathleen Burt, Middle Georgia State University

- |          |   |                    |
|----------|---|--------------------|
| 11:00 am | (a) <b>Anglo-Turkish Interplay in Medieval Romances: <i>The Turku and Sir Gawain</i></b><br><i>Filiz Barin Akman</i> , University of Ankara                                   |                    |
| –        | (b) <b>Silence Interrupted: Reading <i>Le Roman de Silence</i> as a Narrative of (Re)Transition</b>   | <u>Third Floor</u> |
| 12:30 pm | <i>Zachary Clifton Engledon</i> , University of Indiana–Bloomington   | PD 1               |
|          | (c) <b>‘In this worlde here ther is reste none’: Laboring and Resting Bodies in Middle English Drama</b><br><i>Benjamin Howard Hoover</i> , University of Indiana–Bloomington |                    |
|          | (d) <b>Reading Awkward Medieval Bodies: Between Rapture and Ill Health</b><br><i>Yea Jung Park</i> , Saint Louis University   |                    |
- 
- 

**7. Reproductive Biopolitics and Ecology in Recent Iberian and Latin American Cultural Production**

*Pre-Organized Panel*

Chair: William Viestenz, University of Minnesota–Twin Cities

- |          |  |                    |
|----------|--|--------------------|
| 11:00 am | (a) <b>Untidy Creatures: On the Generative in Rafael Bernal’s <i>Su nombre era muerte</i></b><br><i>John Trevathan</i> , University of Missouri–St. Louis<br><i>Justin Butler</i> , University of Missouri |                    |
| –        | (b) <b>Genetically Predisposed for Bad Business: Fathers and Sons in Isaac Rosa’s <i>Lugar seguro</i></b>  | <u>Third Floor</u> |
| 12:30 pm | <i>Erma Nežirevic</i> , University of Minnesota–Twin Cities  | PD 3               |
|          | (c) <b>An Ethics of Care in Chemical-Age Literature: Benjamín Labatut’s <i>Un verdor terrible</i> and Fernanda Trías’s <i>Mugre Rosa</i></b><br><i>Timothy Frye</i> , Independent Scholar                  |                    |
|          | (d) <b>Affirmative Biopolitics as Care in Pilar Codony’s <i>Distòcia</i></b><br><i>William Viestenz</i> , University of Minnesota–Twin Cities  |                    |
- 
-

## 8. Science and Fiction

*Permanent Section: Science and Fiction*

Chairs: Nesrine Affara, Carnegie Mellon University Qatar

Jeffrey Squires, Carnegie Mellon University Qatar

- |          |   |                    |
|----------|---|--------------------|
| 11:00 am | (a) <b>The Science of Health in the Science Fiction of “The Plague Doctors” and “The Algorithm Will See You Now”</b><br><i>Jarrel De Matas</i> , University of Massachusetts–Amherst                              | <u>Third Floor</u> |
| –        | (b) <b>Poisoned Flesh: Bodily and Global Contamination in Ruth Ozeki’s <i>My Year of Meats</i> and Karen Tei Yamashita’s <i>Tropic of Orange</i></b><br><i>Caroline Hensley</i> , University of Wisconsin–Madison | PD 4               |
| 12:15 pm | (c) <b>“My Blood is Magic”: The Birth of the Posthuman</b><br><i>Nesrine Affara</i> , Carnegie Mellon University Qatar<br><i>Jeffrey Squires</i> , Carnegie Mellon University Qatar                               |                    |
- 
- 

## 9. Extra-Illustrated Dickens

*Undergraduate Research Symposium: Pre-Organized Panel*

Chair: Carolyn Jacobson, Grinnell College

- |          |   |                    |
|----------|---|--------------------|
| 11:00 am | (a) <b>Extra-Illustration and Transformative Book Arts of the Turn of the Century</b><br><i>Elliana Cierpiot</i> , Grinnell College   | <u>Third Floor</u> |
| –        | (b) <b>Sentiment, Materiality, and Celebrity Consumption via the Extra-Illustrated <i>Life of Charles Dickens</i></b><br><i>Sophie Kempenaar</i> , Grinnell College                   | PD 5               |
| 12:15 pm | (c) <b>The Most Authentic Intimate Link Between the Present and the Greatness of the Past’: The Role of Letters in Extra-Illustration</b><br><i>Wallis Shepard</i> , Grinnell College |                    |
- 
- 

## 10. Workshop: Naming Linguistic Violence

*Pre-Organized Workshop*

Presenter: Gabriela Veronelli, Northeastern Illinois University

(description continues on the back)

Thursday, November 14

“When we speak and are listened to, we are able to begin healing the wounds created by our past and present lives” (Chabram-Dernersesian & Torre).

11:00 am This workshop utilizes the Latina/Chicana feminist methodology of plática to foster community-building through sharing verbal journeys that voice harms caused by systemic and interpersonal violence. It proposes a space for conversation and recognition, where participants reflect and name linguistic violence in their own terms, based on their personal or witnessed experiences. Through this process, it creates an environment of healing and empowerment, where personal stories contribute to the larger work of undoing coloniality of language.

–

12:15 pm

Third Floor  
PD 7

---

---

## 11. Mental Health and Memoir

Moderator: *To Be Determined*

(a) **Surviving the War: *The Gift* and H.D.’s Divine Maternal Legacy**  
*Samantha Lepak*, Loyola University Chicago

11:00 am

–

12:15 pm (b) **Psychosocial Adaptation: Clifford Whittingham Beer’s *A Mind That Found Itself*, Manic-Depressive Psychosis and the Manufacture of Mental Health in Modern America**  
*Christian Gelder*, Macquarie University–Sydney

(c) **Cutting to the Heart of the Matter: Narration as Surgery in Jean Rolin’s *Savannah***  
*Luke A. Ptak*, University of Wisconsin–Madison

Fourth Floor  
Room 4-A

---

---

## 12. Religion and Literature

*Permanent Section: Religion and Literature*

Chair: Seth Johnson, University of Alabama

12:45 pm (a) **The Clerical Mystery: Detection, Religion, and Community**  
*Doug Sheldon*, University of Illinois–Chicago

–

2:15 pm (b) **Castles of Health: Institutions for Reading in/of Spenser**  
*John Walters*, University of Alabama

(c) **What *Inferno* and *The Satanic Bible* Have in Common: A Literary Satanist Perception of Death and the Afterlife**  
*Alice Wilson*, University of Louisiana - Lafayette

Third Floor  
PD 1



Thursday, November 14

(d) **A Conspiracy Against Itself: Campus Novels and a Loss of Faith in the Academy**

*Seth Johnson*, University of Alabama

---

---

**13. War, Nursing, Narrative**

*Pre-Organized Panel*

Chair: Douglas Dowland, Ohio Northern University

- |          |   |                    |
|----------|---|--------------------|
| 12:45 pm | (a) <b>Costs of Containment: Narrative Innovation as Psychological Preservation in First World War Nursing Narratives</b> | <u>Third Floor</u> |
| –        | <i>Meg Albrinck</i> , University of Wisconsin–Madison   |                    |
| 2:15 pm  | (b) <b>“The War Is the World”: Theories of Feeling in Women’s Great War Nursing Narratives</b>                            | PD 3               |
|          | <i>Anika Jensen</i> , University of Kentucky  |                    |
|          | (c) <b>“Comfort and Order”: Feeling-Work in Mary Seacole</b>  |                    |
|          | <i>Joshua Gooch</i> , D’Youville University   |                    |
|          | (d) <b>The Invention of Identity in Mary Borden’s “Rosa”</b>  |                    |
|          | <i>Douglas Dowland</i> , Ohio Northern University   |                    |
- 
- 

**14. Teaching Care: Integrating Health Care Themes into Core Writing and Literature Courses**

*Pre-Organized Panel*

Chair: Vincent Casaregola, Saint Louis University

- |          |  |                    |
|----------|--|--------------------|
| 12:45 pm | (a) <b>“Where to Begin?” A First-Year Seminar in Representations of Health and Illness for Pre-Med and Pre-Health Students</b> | <u>Third Floor</u> |
| –        | <i>Vincent Casaregola</i> , Saint Louis University   |                    |
| 2:15 pm  | (b) <b>Teaching Disability Studies in Literature and Medical Humanities Classrooms</b>   | PD 4               |
|          | <i>Katie Eck Thorman</i> , Saint Louis University  |                    |
|          | (c) <b>Substances to Stanzas: Teaching Poetry at a Treatment Center</b>  |                    |
|          | <i>Christian Rayner</i> , Saint Louis University   |                    |
|          | (d) <b>Why Stories? Three Approaches to Narrative Medicine</b>   |                    |
|          | <i>Dominic Robin</i> , Saint Louis University  |                    |
- 
-

## 15. Workshop: Reimagining the Humanities Through Medicine and Business

*Pre-Organized Workshop*

Presenters: Kristin LaFollette, University of Southern Indiana

Sukanya Gupta, University of Southern Indiana

Richard Ellman, University of Southern Indiana

12:45 pm	This workshop outlines the transformation of a general-education humanities program into two minors in medical humanities and business humanities. This overview will transition into a collaborative discussion about the opportunities and practical implementation of similar program on participants' own campuses. The collaborative discussion will include pooling advice about the specific needs of different types of institutions, outlining the challenges of program development and implementation, and discussing the development of applied humanities gateway courses.	<u>Third Floor</u> PD 7
–		
2:00 pm		

---

---

## 16. Queer Representations on the Twentieth-Century Page and Stage

Moderator: *To Be Determined*

12:45 pm	(a) <b>A Queer Realization: The Queer Modern Novel Fully Formed</b>	<u>Fourth Floor</u> Room 4-A
–	<i>Anne Garnig Lucas</i> , Kent State University	
2:00 pm	(b) <b>Liberal Empathy and Radical Sexualities: Staging AIDS in Gay Theatre 1980s–2000</b>	
	<i>Jared O'Connor</i> , University of Illinois–Chicago	

---

---

## 17. The (In)Human Experience in Science Fiction

Moderator: *To Be Determined*

2:30 pm	(a) <b>Kurt Vonnegut's <i>Slaughterhouse-Five</i> and Inherited Trauma: A Study on Self-Censorship</b>	<u>Third Floor</u> PD 1
–	<i>Sierra Getz</i> , University of Brighton	
3:45 pm	(b) <b>“Like Entering a Hall of Mirrors”: <i>Never Let Me Go's</i> Politics of Empathy</b>	
	<i>Aileen Tierney</i> , University of Iowa	
	(c) <b>“Unretrainability” and the Benefits of Arts and Humanities in Post-2008 Fictions of AI</b>	
	<i>Elizabeth Burom-Flak</i> , Valparaiso University	

---

---

## 18. The Vision of Versions in Twentieth-Century Fiction and Film

Moderator: *To Be Determined*

- |         |   |                    |
|---------|---|--------------------|
| 2:30 pm | (a) <b>Translating Sickness: Metaphoric Shifting in the German Translations of <i>The Sun Also Rises</i></b><br><i>Christopher Dick</i> , Tabor College | <u>Third Floor</u> |
| –       | (b) <b>Theorizing <i>Forbidden Planet</i> as a Science Fiction Adaptation of Shakespeare</b><br><i>Noah Slowik</i> , University of Delaware             | PD 3               |
| 3:45 pm | (c) <b>Dirty Maximalism: Robert Altman's Revision of Carver Country</b><br><i>Jason Arthur</i> , Rockhurst University                                   |                    |
- 
- 

## 19. Chivalric Myths of Female Chastity: Revision and Resistance

*Undergraduate Research Symposium*

Moderator: *To Be Announced*

- |         |  |                    |
|---------|--|--------------------|
| 2:30 pm | (a) <b>The Significance of the 1596 Revision in Interpreting the House of Busirane</b><br><i>Kait Harland</i> , Trinity Christian College                        | <u>Third Floor</u> |
| –       | (b) <b>“A White Woman’s Falsehood”: Myths of Chivalry and Black-on-White Rape in Ida B. Wells’s Pamphlets</b><br><i>Haley M. Bateman</i> , Elizabethtown College | PD 5               |
| 3:45 pm |  |                    |
- 
- 

## 20. Affective Experience and the Amelioration of Health Care

Moderator: *To Be Determined*

- |         |  |                     |
|---------|--|---------------------|
| 2:30 pm | (a) <b>From English Professor to Therapist: A Case Study</b><br><i>Jonathan Ritz</i> , Michigan State University   |                     |
| –       | (b) <b>Historical Trauma and Health Literacy: Cultivating Culturally Attuned Informed Consent in Native American Women’s Healthcare</b><br><i>Mafruha Shifat</i> , North Dakota State University | <u>Fourth Floor</u> |
| 3:45 pm | (c) <b>“Annie, Annie, Are You Okay?”: L’Inconnue and the Visual Culture of Simulated Human Models</b><br><i>Sookyong Ko</i> , University of California–San Diego                                 | Room 4-A            |
- 
-

---

---

## 21. Impactful Environments: Natural and Architectural

Moderator: *To Be Determined*

- |         |   |                    |
|---------|---|--------------------|
| 4:00 pm | (a) <b>The Power of Natural Remedies in <i>The Secret Garden</i></b><br><i>Matthew Carlson</i> , High Point University      | <u>Third Floor</u> |
| –       | (b) <b>Toward an Interconnected Climate Response: Agency and Subject-Object Relationships in <i>The Grapes of Wrath</i></b> | PD 1               |
| 5:15 pm | <i>Jesse Carter</i> , Truman State University   |                    |
|         | (c) <b>Creepy Ivy: Invasive Landscape, Invasive Architecture, and the Hysterical City</b>                                   |                    |
|         | <i>Elizabeth Marley</i> , University of Illinois–Chicago  |                    |
- 
- 

## 22. Literary Intersections of Women and Aging

Moderator: *To Be Determined*

- |         |  |                    |
|---------|--|--------------------|
| 4:00 pm | (a) <b>“They Returned Again into The Past”: Aging and Time in <i>Persuasion</i></b><br><i>Melanie Zynel</i> , Central State University | <u>Third Floor</u> |
| –       | (b) <b>The Ethics of Care and Ways of Aging in Sigrid Nunez’s <i>What Are You Going Through</i></b>                                    | PD 3               |
| 5:15 pm | <i>Amelia Chen</i> , University of Oregon  |                    |
|         | (c) <b>Ageism-Sexageism and Cultural Resistance in Contemporary Spanish Graphic Novel</b>  |                    |
|         | <i>Yomary Carrillo Tequia</i> , University of Minnesota  |                    |
- 
- 

## 23. Methods in Literary Criticism

*Permanent Section: Literary Criticism*

Chair: Joel Wendland-Liu, Grand Valley State University

- |         |  |                    |
|---------|--|--------------------|
| 4:00 pm | (a) <b>Strange Symptoms: Metaphor, Interpretation and the Uncanny</b><br><i>Delmar Reffett</i> , Kentucky State University                     | <u>Third Floor</u> |
| –       | (b) <b>African Drama: A Literary Look into the Mental Health of Wole Soyinka’s <i>Kongi’s Harvest</i> Characters through Social Psychology</b> | PD 4               |
| 5:15 pm | <i>Adesanya M. Alabi</i> , Independent Scholar   |                    |

(panel continues on the back)

Thursday, November 14

(c) **The “Wandering” You: Langston Hughes and Revolutionary Fugitivity**

*Joel Wendland-Liu*, Grand Valley State University

---

---

**24. Autonomy, Authority, and Accessibility: Representations of Disability in Film and Literature**

*Permanent Section: Disability Studies*

Chair: John Allen, Milwaukee Area Technical College

- |         |   |                     |
|---------|---|---------------------|
| 4:00 pm | (a) <b>AI and the Blind Gaze: Translating Blind Subjectivity into AI-generated Cinema in <i>The Blind Canvas Project (2023)</i></b> | <u>Fourth Floor</u> |
| –       | <i>Eduardo Ledesma</i> , University of Illinois–Urbana-Champaign  |                     |
| 5:15 pm | (b) <b>Authentic Representation of Intellectual Disability in Literary Texts from <i>Algernon</i> to AI</b>                         | Room 4-A            |
|         | <i>John Allen</i> , Milwaukee Area Technical College  |                     |
|         | (c) <b>(In)Accessibility: Fantastical Prosthetic in Dinah Mulock Craik’s <i>The Little Lame Prince</i></b>                          |                     |
|         | <i>Emily Jones</i> , University of Minnesota–Twin Cities  |                     |
- 
-

# Friday, November 15

## Book Exhibit:

8:00 am – 5:00 pm; Third Floor, Waldorf

## CV Drop-In Workshop:

10:00 am – 4:00 pm; Third Floor, PD 6

---

---

## 25. Varying Views of Authorship: Traveler, Laborer, Machine

Moderator: *To Be Determined*

- |         |  |                    |
|---------|--|--------------------|
| 8:00 am | (a) <b>Pandemic Travel Writing and the Future of Travel</b><br><i>Susanna Hoeness-Krupsam</i> , University of Southern Indiana | <u>Third Floor</u> |
| –       | (b) <b>But Money Is Not I: Writing the American Writer</b><br><i>Ross Tangedal</i> , University of Wisconsin–Stevens Point     | PD 1               |
| 9:15 am | (c) <b>Can Xue, Automatic Writing, and the Force of Exhaustion</b><br><i>Dong Yang</i> , Grinnell College                      |                    |

---

---

## 26. Mental Health Representations in Global Literature

*Permanent Section: Postcolonial and Decolonial Studies*

Chair: Jose Intriago Suarez, Marquette University

- |         |   |                    |
|---------|---|--------------------|
| 8:00 am | (a) <b>Representations of Eating Disorders among Teenage Girls in the Global South: The Character of Nyasha in Tsiti Dangarembga's <i>Nervous Conditions</i></b><br><i>Maddie Belland</i> , Loyola University Chicago | <u>Third Floor</u> |
| –       | (b) <b>The Race of the Dis-qualified: Literary Representations of the Intersection of Racial and Neurological Otherness</b><br><i>Sinchan Chatterjee</i> , University of California–Berkeley                          | PD 3               |
| 9:15 am | (c) <b>Aesthetic Nervousness: The Reading of <i>Broken Glass</i></b><br><i>Najma Ibrahim</i> , Marquette University   |                    |

## 27. Engaging Health in the Undergraduate Classroom

Moderator: *To Be Determined*

- |         |   |                    |
|---------|---|--------------------|
| 8:00 am | (a) <b>Interventions in the Liberal Arts Classroom Setting:<br/>Prioritizing Mental Health and Belonging in Spanish for<br/>the Professions</b> | <u>Third Floor</u> |
| –       | <i>Amanda Rector, Wartburg College</i>  | PD 4               |
| 9:15 am | (b) <b>Healthy Debates: Narrative, Rhetoric, and Poetic<br/>Prescriptions in an Undergraduate Medicine &amp;<br/>Literature Classroom</b>       |                    |
|         | <i>Amy Gates, Missouri Southern State University</i>  |                    |
- 
- 

## 28. Workshop: Using Word Embedded Models for Close Reading

*Pre-Organized Workshop*

Presenter: Heejoung Shin, University of Illinois–Chicago

- |         |  |                    |
|---------|--|--------------------|
| 8:00 am | How can machine learning be productively and “healthily” used to explore particularity and facilitate close reading? This 2-hour workshop aims to respond to this question by learning word embedding models that convert words into vectors and map a text corpus as a network of words based on semantic similarity. This makes any groups of words identified as figuratively and semantically close to one another across a certain author’s corpus available for exploration. There will be hands-on activities, alongside the tools and knowledge needed for these types of computational literary studies. Basic understanding of Python is recommended but not required. | <u>Third Floor</u> |
| –       |  | PD 7               |
| 9:15 am |  |                    |
- 
- 

## 29. Re-Imagining Decolonial Narratives #1

*Permanent Section: Women in French*

Chair: Nevine Nossery, University of Wisconsin–Madison

- |         |   |                     |
|---------|---|---------------------|
| 8:00 am | (a) <b>The Desert Revisited: Disrupting Environmental<br/>Colonial Narratives</b> | <u>Fourth Floor</u> |
| –       | <i>Hanan Elsayed, Occidental College</i>  | Room 4-A            |
| 9:15 am | (panel continues on the back)   |                     |

Friday, November 15

- (b) **Mémoires en contrepoint. L'Algérie et ses histoires (re)construites**  
*Nevine Nossery*, University of Wisconsin–Madison
- (c) **Navigating Cultural Borders: The Decolonized Narrative of Iranian Diaspora Writers in the US**  
*Navid Etedali*, University of New Mexico

---

---

### 30. The Women of Nineteenth-Century American Literature: Disability, Hysteria, and Self-Education

Moderator: *To Be Determined*

- 8:00 am (a) **Recognizing Disability Myths in Julia Ward Howe's *The Hermaphrodite* by Acknowledging Intersections Between Gender, Sexuality, and Disability**  
*Manuel Alonzo*, California State University–Stanislaus Fourth Floor
- (b) **Finding Freedom for the Unnatural Woman: Reclaiming Hysteria from Medical Men via Literature and Contemporary Dance**  
*Savannah Willard*, University of Edinburgh Room 4-B
- 9:15 am (c) **“My distant patients”: Women's Health Advocacy in Mary Gove Nichols**  
*Kristen Egan*, Mary Baldwin University

---

---

### 31. Spanish Cultural Studies

*Permanent Section: Spanish Cultural Studies*

Chair: Kathy Korcheck, Central College

- 8:00 am (a) **Healing from Jet-Lag, Death, and Exile**  
*Ana Roncero-Bellido*, Lewis University Fourth Floor
- (b) **“Yo también soy”: Challenging Undergraduates to Interrogate National Belonging Through the Study of Memoir**  
*Emily DiFilippo*, Loras College Room 4-E
- 9:15 am (c) **Millennial *Desencanto* and the Politics of Nostalgia in *Facendera* (Óscar García Sierra, 2022)**  
*Darío Sánchez González*, Gustavus Adolphus College



### 32. Women's Wars

*Associated Organization: Civil War Caucus*

Organizer: Kathleen Diffley, University of Iowa

Chair: Shirley Samuels, Cornell University

- 8:30 am (a) **Melville's Wives' Bodies**  
*Rachel Banner*, West Chester University
- (b) **Transformation, Transition, and Translation: How Sarah Emma Edmonds Crossed Confederate Lines** Fourth Floor  
*Sarah E. Chinn*, Hunter College–CUNY Room 4-D
- 10:00 am (c) **“Like Those Pretty Engravings on the Backs of Fans?”: Manassas, Constance Cary, and the *Southern Illustrated News***  
*Kathleen Diffley*, University of Iowa
- (d) **Phoebe Pember's Haunted Postwar**  
*Sarah E. Gardner*, Mercer University
- 
- 

### 33. Love, Lust, and the Romantic Sublime: Blindness and Insight into Health and Well-Being in Frankenstein and Other Romantic Period Texts

*Pre-Organized Panel*

Chair: Jonathan Gross, DePaul University

- 9:30 am (a) **Exploring the Dichotomy of Desire: Lust and Love in Romantic Poetry, Studied Works by Keats, Blake, and Millais** Third Floor  
*Carmen Romero Lopez*, DePaul University PD 1
- (b) **Romantic Vegetarianism and the Health of the Body Politic**  
*Rebecca Hathaway*, DePaul University
- 10:45 am (c) **Hail holy Light: Milton, Mary Shelley, & Burke's Dark Sublime**  
*Zach Cleir*, DePaul University
- 
- 

### 34. Remnants of Imperialism and Colonialism in Health Care

*Permanent Section: Postcolonial and Decolonial Studies*

Chair: Jose Intriago Suarez, Marquette University

Friday, November 15

- 9:30 am (a) **Tanure Ojaide's *Narrow Escapes: COVID-Postcolonialism and the Vulnerability of the Empire Builders***  
– *Ibrahim Nureni*, Louisiana State University Third Floor
- 10:45 am (b) **Ethical Approaches to Care through World Literature in Translation**  
*Soraya Zarook*, Old Dominion University PD 3
- (c) **American Medical Imperialism and Haitian "Home" Remedies in Edwidge Danticat's *Brother, I'm Dying***  
*Caroline Hensley*, University of Wisconsin–Madison
- 
- 

### 35. Teaching and Tutoring Writing in the Humanities

Moderator: *To Be Determined*

- 9:30 am (a) **Sensorial Literacy and Gastro Lexicon: Exploring the Role of Food Rhetorics as Cultural Metaphor in Creative Writing Praxis**  
– *Saima Afreen*, Illinois State University Third Floor
- 10:45 am (b) **Emotional Labor and Emotional Intelligence in the Writing Center**  
*Grace Williams*, Wayne State University PD 4
- 
- 

### 36. The Female Body in Literature: Identity, Agency, and Trauma

*Undergraduate Research Symposium*

Moderator: *To Be Announced*

- 9:30 am (a) **Challenging Polyphony's Role in Addressing Trauma and Mental Stress in Contemporary East Asian Women's Literature**  
– *Yiyao Sun*, University of Chicago Third Floor
- 10:45 am (b) **Commercialized Violence Reimagined in the Women of Dreiser and Chesnutt**  
*Morgan Nicole Fuksa*, Loyola University Chicago PD 5
- 
- 

### 37. Re-Imagining Decolonial Narratives #2

*Permanent Section: Women in French*

Chair: *Nevine Nossery*, University of Wisconsin–Madison

Friday, November 15

- 9:30 am (a) **La nouvelle poétique du monde de Léonora Miano: Le deuil des mères « dont le fils n'ont pas été retrouvés »**  
*Frederique Chevillot*, University of Denver
- (b) **Dialectic Returns: Reconfiguring the Zombie Mythos and Female Postcolonial Identity in Mati Diop's *Atlantique*** Fourth Floor  
*Brittany Bernard*, Boston University Room 4-A
- 10:45 am (c) **Sexuality and Statecraft: The Strategic and Ideological Weaponization of Gender in the Algerian War of Independence**  
*Amelle Zeroug*, Brown University
- 
- 

### 38. The Men of Nineteenth-Century American Literature: Religion, Intention, and Conviction

Moderator: *To Be Determined*

- 9:30 am (a) **Ahab's Bible, Starbuck's Bible, Melville's Bibles: Religion and the Almighty Dollar in *Moby-Dick***  
*Dean Mendell*, Touro University Fourth Floor
- (b) **The Problem with Words: Authorial Intention and Meaning in Poe's The Narrative of Arthur Dordon Pym and "The Black Cat"** Room 4-B  
*Haley Ramirez*, Loyola University Chicago
- 10:45 am (c) **Well-being, Longevity, and Walt Whitman's Late Writings**  
*Kenneth Price*, University of Nebraska–Lincoln
- 
- 

### 39. Social Media's Impact in Research and the Marketplace

Moderator: *To Be Determined*

- 9:30 am (a) **Practicing a Digital Ethic of Care amid the Complexities and Implications of Sharing Stories of Reproductive [in]Justice Across Social Media** Fourth Floor  
*Danielle Koepke*, Marquette University Room 4-C
- (b) **Watch Closely: Reactions, Social Media Entertainment, and Commodifying Connection**
- 10:45 am *Kelsey Roberts*, University of Wisconsin–Milwaukee
- 
-

#### 40. Intersections of Ecofeminism and Ecocriticism: Revisiting Literary Narratives in Catalan and Spanish Contexts

*Permanent Section: Spanish II, Spanish Peninsular Literature after 1700*

Chair: Yenisei Montes de Oca, James Madison University

- |          |  |                     |
|----------|--|---------------------|
| 9:30 am  | (a) <b>Female Bodies and the Rewriting of the Human-Nature Divide in <i>Canto yo y la montaña baila</i> (2019)</b> | <u>Fourth Floor</u> |
| –        | <i>Alyssa Holan</i> , University of Wisconsin–Platteville  | Room 4-E            |
| 10:45 am | (b) <b>Spanish Postwar Literature is Fertile Ground for Ecocriticism</b>   |                     |
|          | <i>Nathan McBride</i> , Ohio State University  |                     |
- 
- 

#### 41. Representing the Klan

*Associated Organization: Civil War Caucus*

Organizer: Kathleen Diffley, University of Iowa

Chair: John Levi Barnard, University of Illinois–Urbana-Champaign

- |          |   |                     |
|----------|---|---------------------|
| 10:15 am | (a) <b>An Earlier “Red Record”: Towards a Critique of Antebellum Anti-Black Lynching</b>  |                     |
| –        | <i>John Cyril Barton</i> , University of Missouri–Kansas City   | <u>Fourth Floor</u> |
| 11:45 am | (b) <b>Enforcing and Redeeming the Fourteenth Amendment: State and Federal Ku Klux Klan Trials in North Carolina, 1870–1871</b> | Room 4-D            |
|          | <i>Jerry Chen</i> , Harvard University  |                     |
|          | (c) <b>“Stranger than Fiction”: Thomas Dixon’s Idealized Klan</b>   |                     |
|          | <i>Katherine Lennard</i> , University of Western Kentucky   |                     |
|          | (d) <b>Grant’s Pardoning of the Klan and Thomas Dixon Jr.’s <i>The Traitor</i></b>  |                     |
|          | <i>Brook Thomas</i> , University of California–Irvine   |                     |
- 
- 

#### 42. Trauma and Healing in Native American Literature

*Permanent Section: Native American Literature*

Chair: Kate Beutel, Lourdes University

- |  |  |  |
|--|--|--|
|  | (a) <b>Healing, Trauma, and Re-envisioning Futures: Indigenous Hip Hop as Literary Texts</b> |  |
|  | <i>Jonah Francese</i> , University of Chicago  |  |

Friday, November 15

- (b) **The Fictional Rez as Trauma Center: Native Crime Novels and Communal Well-Being**  
*Cyanne So-lo-li Topaum*, University of Illinois–Urbana-Champaign
- 11:00 am (c) **Healing Stories in the Poetry of Natalie Diaz** Third Floor  
– *Shawna Rushford-Spence*, Lourdes University PD 1
- 12:30 pm (d) **Extractive Colonialism, Misogynist Violence, and Indigenous Resistance in HBO’s *True Detective: Night Country***  
*Delia Byrnes*, Allegheny College
- 
- 

#### 43. The Relationship of Visibility, Silences, Power, and Sickness in Midwestern Literary Texts

*Associated Organization: Society for the Study of Midwestern Literature*

Chair: Marilyn Judith Atlas, Ohio University

- (a) **Is *Winesburg, Ohio*’s George Willard an Unwitting Contributor to His Neighbors’ Neuroses?**  
*Robert Dunne*, Central Connecticut State University
- 11:00 am (b) **Foucauldian Medical Perception and the Modern Midwest in Sinclair Lewis’s *Arrowsmith*** Third Floor  
– *Shaun F. Richards*, Finger Lakes Community College PD 3
- 12:30 pm (c) **“Weathering” and Tillie Olsen’s *Tell Me a Riddle* as Midwestern Cautionary Tale**  
*Marilyn Judith Atlas*, Ohio University
- (d) **“We can’t stop living”**: Not Enough Heartland Love for Carmen Maria Machado’s Queer Midwest Memoir, *In the Dream House* (2019)  
*Patrick S. Allen*, Elizabethtown College  
*Haley M. Bateman*, Elizabethtown College
- 
- 

#### 44. Healing Identity and Illness in the Art of Storytelling and the Narrative

*Permanent Section: Race, Gender, and Subalternity*

Chair: Tamara D. Hill, Clark Atlanta University

- (a) **Narratives of Illness and Identity: Examining the Role of Storytelling, Community, and Healing in Ntozake Shange’s *for colored girls who have considered suicide when the . . .***

Friday, November 15

*rainbow is enuf*

*Ondra Dismukes*, Morehouse College

- |          |  |                    |
|----------|--|--------------------|
| 11:00 am | (b) <b>Nidali, Deya, and _____ in America: Narratives of Illness and Identity</b>  | <u>Third Floor</u> |
| –        | <i>Joy Mazabreh</i> , University of Minnesota–Twin Cities  | PD 4               |
| 12:30 pm | (c) <b>The Black Church: A Sanctuary of Radical Politics in Modern African American Literature</b>   |                    |
|          | <i>Ryan Poll</i> , Northeastern Illinois University  |                    |
|          | (d) <b>The Journey Home: The Consequences of Societal Displacement and the Importance of Returning to The Landing as a Response to Intra-racial Detachment</b> |                    |
|          | <i>Thomas Forrest</i> , University of Minnesota  |                    |
- 
- 

#### 45. Somewhere and Nowhere: Uncanny Environments in Sci-Fi Television

*Undergraduate Research Symposium: Pre-Organized Panel*

Chair: Keli Masten, Ferris State University

- |          |   |                    |
|----------|---|--------------------|
| 11:00 am | (a) <b>Unveiling the 2000s Digital Gothic: A Critical Analysis of Torchwood's "Ghost Machine"</b> | <u>Third Floor</u> |
| –        | <i>Grace Muchmore</i> , Ferris State University   | PD 5               |
| 12:15 pm | (b) <b>Trapped in a Wrought Iron Cage: The Bradbury Building and Android Identity</b>             |                    |
|          | <i>Erin Graham</i> , Ferris State University  |                    |
|          | (c) <b>Dark: Religiosity and Paradox</b>  |                    |
|          | <i>Heather Stephens</i> , Ferris State University   |                    |
- 
- 

#### 46. Professionalizing Session: AI Pedagogy Workshop

Presenter: *Nathan A. Jung*, University of Wisconsin–Madison

- |          |  |                    |
|----------|--|--------------------|
| 11:00 am | This session will explore the possibilities and pitfalls of generative AI in the humanities classroom. Through several practical examples and exercises, the workshop will provide space for attendees to learn from one another about how AI has impacted their pedagogy in areas like course design, assignments, administrative work, and course content. | <u>Third Floor</u> |
| –        |  | PD 7               |
| 12:15 pm |  |                    |
- 
-

## 47. Narratives of Health(s): Exploring Positionalities through the Medical Humanities Lens #1

*Permanent Section: Women in Literature*

Chair: Sayanti Mondal, Ithaca College

- 11:00 am
- 
- 12:30 pm
- (a) **Going Mad in Area X: A Mad Studies Approach to Jeff VanderMeer’s *Southern Reach* Trilogy**  
*Heather O’Leary*, University of Illinois–Chicago
  - (b) **‘Continuity in Discontinuity’: Interpreting the Practice of ‘Narrative Care’ for Alzheimer’s in Select Indian Literary Texts**  
*Debashrita Dey*, Indian Institute of Technology–Patna
  - (c) **The Breath Between Heartbeats: A Narrative Medicine Approach to Understanding how Film and Documentary Portray Black Female Pain and “Unfit Mothers”**  
*Rosemary O’Mahony*, Columbia University  
*Sarah Caston*, Columbia University  
*Deborah Denmen*, Columbia University  
*Malaika Jawed*, Columbia University
  - (d) **The Pharmakoi of the Deep South: Corporeality and Interiority in Conflict in Carson McCullers’ Fiction**  
*Giovana Proença Gonçalves*, Universidade de São Paulo
- Fourth Floor  
Room 4-A
- 
- 

## 48. Writing Illness, Embodiment, and Care in Fiction and Creative Nonfiction

*Permanent Section: Creative Writing I, Prose*

Chair: Patrick Thomas Henry, University of North Dakota

- 11:00 am
- 
- 12:30 pm
- (a) ***The Three of Them***  
*Zeke Jarvis*, Eureka College
  - (b) ***She Herself Is a Haunted House: Writing Postpartum Psychosis in(/of) Gothic Fiction***  
*Georgia Poplett*, Durham University
  - (c) ***Contingent Contingencies***  
*Leah McCormack*, University of South Dakota
  - (d) **The Life and Afterlife of Breast Cancer: A Reading and Discussion on Process**  
*S. L. Wisenberg*, Independent Scholar
- Fourth Floor  
Room 4-B
- 
-

## 49. Labor, Leisure, and Idleness in Luso-Brazilian Cultures #1

*Permanent Section: Luso-Brazilian Studies*

Chair: Isabela Fraga, Tufts University

- |          |   |                                 |
|----------|---|---------------------------------|
| 11:00 am | (a) <b>Living Beyond Terms: The Political Imaginaries of the Urban Poor Free and Freed in Rio de Janeiro, 1870–1910</b><br><i>Gabriel Azevedo Duarte Franco</i> , University of Chicago | <u>Fourth Floor</u><br>Room 4-E |
| –        | (b) <b>Standing Still: Idleness and Labor in the Plantation</b><br><i>Isabela Fraga</i> , Tufts University  |                                 |
| 12:30 pm | (c) <b>Macunaíma of the Beautiful Game: Garrincha’s Subversive Idleness in Brazilian Soccer, Art &amp; Society</b><br><i>Jack A. Draper III</i> , University of Missouri                |                                 |
|          | (d) <b>Queering the <i>Brasiliana</i> Archive: Gê Viana’s Afro-Indigenous Critique of Labor</b><br><i>Susana Costa Amaral</i> , New York University                                     |                                 |
- 
- 

## 50. Taking Survey of the Survey of English

*Permanent Section: English I, English Literature before 1800*

Chair: Adam H. Kitzes, University of North Dakota

- |          |  |                            |
|----------|--|----------------------------|
| 12:45 pm | (a) <b>Bodies, Objects of Placement, Pedagogy in Jane Barker’s <i>Love Intrigues</i> (1713)</b><br><i>Hye Hyon Kim</i> , Illinois State University   | <u>Third Floor</u><br>PD 1 |
| –        | (b) <b>Refashioning English Literature Survey Courses for Cross-Cultural Inclusivity and Coverage: Romantic Orientalism and Literary Interplays Between East and West</b><br><i>Filiz Barin Akman</i> , Social Sciences University of Ankara |                            |
| 2:15 pm  | (c) <b><i>The Wedding</i> or <i>The Wife</i>? Rethinking the Texts We Include for Survey</b><br><i>Kyle Robert Moore</i> , University of North Dakota  |                            |
|          | (d) <b>Fire and History: Alternative Chronologies in the Survey of English Literature</b><br><i>Adam H. Kitzes</i> , University of North Dakota  |                            |
- 
-



## 51. Medical Dispositives: Texts, Images, Spaces

*Pre-Organized Panel*

Chair: Matthew Senior, Oberlin College

- |          |   |                    |
|----------|---|--------------------|
| 12:45 pm | (a) <b>War Wounds: On the Painted Image and the Injuriousness of History</b><br><i>David Clark</i> , McMaster University  |                    |
| –        | (b) <b>Charité Hospital in Berlin: Community, Immunity, Biopolitics</b><br><i>Jennifer Ham</i> , University of Wisconsin–Green Bay  | <u>Third Floor</u> |
| 2:15 pm  | (c) <b>The Sacred Exception in Beckett’s <i>Le Dépeupleur</i></b><br><i>Ian Curtis</i> , Kenyon College   | PD 3               |
|          | (d) <b>Medical or Narratological Dispositives: Text, Body, and Images in Steve Tomsula’s <i>VAS</i></b><br><i>Hanna Hadjadj</i> , University of Paris 8–Vincennes-Saint-Denis |                    |
- 
- 

## 52. Peace, Literature, and Pedagogy

*Permanent Section: Peace, Literature, and Pedagogy*

Chair: Alexander B. Johns, University of North Georgia

- |          |   |                    |
|----------|---|--------------------|
| 12:45 pm | (a) <b>Narrative Resolutions: Blueprints for Recovery in Kenneth Grahame’s “The Reluctant Dragon” and Ted Hughes’s <i>The Iron Giant: A Story in Five Nights</i></b><br><i>Heather Joyce</i> , Northwestern Polytechnic | <u>Third Floor</u> |
| –        | (b) <b>Teaching Writing through Collective Witness: Contagion Narratives and Students’ Lived COVID-19 Experiences</b><br><i>Devyn Andrews</i> , University of Illinois–Chicago  | PD 4               |
| 2:15 pm  | (c) <b>German in South Dakota: Promoting Intercultural Competence by Utilizing Local German Heritage</b><br><i>Nathan J. Bates</i> , University of South Dakota   |                    |
|          | (d) <b>R/Askalex: Reddit Replies as Poetic Practice</b><br><i>Alexander B. Johns</i> , University of North Georgia  |                    |
- 
- 

## 53. Professionalizing Session: Getting it Published, Articles

Presenter: *Olga Bezhanova*, Southern Illinois University–Edwardsville

(description continues on the back)

Friday, November 15

12:45 pm This session will cover all stages of the publication process for an academic article. We will talk about establishing a workable and productive writing schedule, choosing a venue, approaching the editors, and navigating the different stages of the publication process. We will explore how to create and inhabit a scholarly persona and discuss the difficulties experienced by scholars from marginalized communities as they position themselves as research scholars.

–

2:15 pm

Third Floor  
PD 7

---

---

## 54. Narratives of Health(s): Exploring Positionalities through the Medical Humanities Lens #2

*Permanent Section: Women in Literature*

Chair: Sayanti Mondal, Ithaca College

12:45 pm (a) **Gendered Pathographies: Differing Graphic Memoirs of a Mother's Terminal Illness**  
*Laura Beadling*, Youngstown State University

–

2:15 pm (b) **Octavia Butler's *Parable of the Sower* and Environmental Political Cartoons: Climate Change Activism of Science Fiction and Satire**  
*Maddie Belland*, Loyola University Chicago

Fourth Floor  
Room 4-A

(c) **Health Humanities on Women's Mental Health in Darryl Cunningham's *Psychiatric Tales* and Rachel Lindsay's *Rx: A Graphic Memoir***  
*Edcel Javier Cintron-Gonzalez*, Illinois State University

(d) **Women, Health, and Comics: Teaching Graphic Medicine**  
*Lan Dong*, University of Illinois–Springfield

---

---

## 55. At the Heart of Things: Illness, Wellness, Poetry

*Permanent Section: Creative Writing II, Poetry*

Chair: Hannah Kroonblawd, Illinois State University

12:45 pm (a) **About the Mountain**  
*Russell Brickey*, Independent Writer

–

2:15 pm (b) **On a Scale from Zero to Ten: Poetry and Women's Pain in Medicine**  
*Haley A. Larson*, Dakota State University

Fourth Floor  
Room 4-B

(c) **Poems for My Father**  
*Cecil Sayre*, Independent Writer

Friday, November 15

- (d) **Vital Signs “Poetry in Response to Illness and Trauma”**  
*Vincent Casaregola*, Saint Louis University
- 
- 

## 56. Representations of the Female Body in Print and Television

Moderator: *To Be Determined*

- 12:45 pm (a) **“An Itching Disease”: Gambling, Gender, and the Language of Contagion in Eighteenth-Century Britain**  
*J. David Macey*, Fort Hays State University Fourth Floor
- (b) **Poetry of the Double: Re-Production in L’Immaculée Conception**  
*Lindsey Richter*, Grace College Room 4-C
- 2:00 pm (c) **Exiting the Vomitorium: Detecting Through Kristeva’s Lens of Abjection**  
*Ruth Williams*, William Jewell College
- 
- 

## 57. Labor, Leisure, and Idleness in Luso-Brazilian Cultures #2

*Permanent Section: Luso-Brazilian Studies*

Chair: *Isabela Fraga*, Tufts University

- 12:45 pm (a) **Frontiers of Labor: Paraguayans at Brazil’s Southwestern Border, 1889–1954**  
*Arthur Schott Lopes*, University of Chicago Fourth Floor
- (b) **Urban Labor Representations in Brazilian Literature from 1930: A Study of Pagu and Erico Veríssimo**  
*Giovana Proença Gonçalves*, University of São Paulo Room 4-E
- 2:15 pm (c) **Field Work: Labor and Culture in Rural Brazil**  
*Thomas Amancio*, University of Chicago
- (d) **Tijolos em Rasantes Voos: Racialized Labor Dynamics and Disability in Conceição Evaristo’s *Um piano para Yá Dulcina***  
*Letícia Barbosa*, University of Wisconsin–Madison
- 
- 

## 58. Emancipation’s Tremors

*Associated Organization: Civil War Caucus*

Organizer: *Kathleen Diffley*, University of Iowa

Chair: *Samuel Graber*, Valparaiso University

Friday, November 15

- (a) **Frederick Douglass, the Screenplay: Reflections on Scripting an Iconic Life**  
*Ian Finseth*, University of North Texas
- 2:15 pm (b) **George Moses Horton and the Landscapes of Southern Romanticism**  
*Faith Barrett*, Duquesne University Fourth Floor
- 
- 4:00 pm (c) **“The Struggle for Freedom”: Rosetta Douglass Publishes a Novel of Black Insurrection**  
*Benjamin Fagan*, Auburn University Room 4-D
- (d) **Remembering the Late War: The SCSA’s 1866–1867 Lecture Course, Black Reconstructions, and William Still**  
*Eric Gardner*, Saginaw Valley State University
- (e) **The Emancipatory Air of Frances Ellen Watkins Harper’s War Poetry**  
*Robert Arbour*, Spring Hill College
- 
- 

## 59. American Literature II: Literature after 1870

*Permanent Section: American Literature II, Literature after 1870*

Chair: Nathan A. Jung, University of Wisconsin–Madison

- 2:30 pm (a) **“A Tech er de Rheumatiz”: Illness and Declining Health in Charles Chesnut’s *The Conjure Woman* and *The Wife of His Youth*** Third Floor  
*Mina Gautier*, University of Miami PD 1
- 
- 3:45 pm (b) **The Mental Health of the Mid-Century American Consumer: The Fiction of Shirley Jackson**  
*Selma Purac*, Western University
- (c) **The Health of the Poet: Mary Ellen Solt, Illness, and Verse**  
*Jennifer Burek Pierce*, University of Iowa
- 
- 

## 60. French II: Post Ancien Régime

*Permanent Section: French II: Post Ancien Régime*

Chair: Noëlle Brown, Kennesaw State University

- (a) **Health and Social Change in Zola’s *Germinal***  
*Tanya Mushinsky*, Southern Illinois University–Edwardsville

Friday, November 15

- 2:30 pm (b) **Anxiety and Depression: The Impossible Career of a Woman Writer in 19th- and 20th-Century France**  
*Noëlle Brown*, Kennesaw State University Third Floor
- (c) **Traumatismes de l'exploitation néocoloniale et quête de guérison identitaire dans "Le Rêve du pêcheur" d'Hemley Boum**  
*Georgy Khabarovskiy*, University of Chicago PD 3
- 3:45 pm
- 
- 

## 61. Illuminating/Collectivizing Infrastructure

*Associated Organization: Association for the Study of Lit and the Environment*

Chair: Brian Deyo, Grand Valley State University

- 2:30 pm (a) **Watershed U: Reading, Learning, and Collectivizing Around Water** Third Floor  
– *Tierney S. Powell*, Grand Valley State University PD 4
- 3:45 pm (b) **Visual Ecopoetry and Empathy towards Nature: Christian Petzold's *Undine***  
*Margarete Landwehr*, West Chester University
- 
- 

## 62. The Rhetorical Framing of Female Bodies in the Public

*Undergraduate Research Symposium*

Moderator: *To Be Announced*

- 2:30 pm (a) **The Modern Witch Hunt: An Analysis of Britney Spears' Media Trials** Third Floor  
– *Nada Abduljalil*, University of Wisconsin–Milwaukee PD 5
- 3:45 pm (b) **Weaving with a Pink Ribbon: An Interdisciplinary Analysis of Cancer Representation and Research Funding in Qatar**  
*Dana Al Disi*, Carnegie Mellon University Qatar
- 
- 

## 63. Gender Studies

*Permanent Section: Gender Studies*

Chair: Hye Hyon Kim, Illinois State University

- (a) **Gender as an Oppressive Intervention into our Shared Humanity**  
*Elliot Koch*, University of California–Riverside

Friday, November 15

- 2:30 pm (b) **Finding Beauty and Identity in the Scar: A Reading of Toni Morrison's *Beloved*** Fourth Floor  
– Room 4-A  
3:45 pm *Kiara Washington*, SUNY–Geneseo College  
(c) **George Brant's Grounded: The Erasure of Pregnant Bodies**  
*Katherine Witt*, University of Wisconsin–Milwaukee
- 
- 

#### 64. Reading for Wellness

*Permanent Section: Creative Writing III, Short Story*

Chair: Heather Joyce, Northwestern Polytechnic

- 2:30 pm (a) **"They are hiding in the mist and ferns": Mediated Narration, (In)direct Experience and Utopia in E.M. Forster's "The Machine Stops"** Fourth Floor  
– Room 4-B  
*Jacqueline Knirnschild*, University of Maine  
3:45 pm (b) **Monkeys and Memories: Selfhood and Storytelling in Haruki Murakami's Shinagawa Monkey Stories**  
*Patrick Thomas Henry*, University of North Dakota  
(c) **Symbolic Value and the Short Story: Affective Objects in Gunnhild Øyehaug's "Apples" and Olga Tokarczuk's "Seams"**  
*Heather Joyce*, Northwestern Polytechnic
- 
- 

#### 65. Living Under Threat: Palestinian and Israeli Films

*Permanent Section: Global Cinema*

Chair: Khani Begum, Bowling Green State University

- 2:30 pm (a) **Whistling Under Occupation: Palestinian Women's Friendship, Longing and Resilience in *The Kingdom of Women* (2010) and *Soraida: A Woman of Palestine* (2004)** Fourth Floor  
– Room 4-E  
*Anne Rothbaas*, Univ. of Cincinnati/Bowling Green State Univ.  
3:45 pm (b) **Seeking Home & Citizenship: History and Memory in Palestinian Films**  
*Khani Begum*, Bowling Green State University  
(c) **"The Most Moral Army in the World": Israeli National Security, a *Casus Belli*, and the Counter Narrative of Hany Abu-Asad's Films**  
*Tim Newman*, Kent State University
- 
-

## 66. International T.S. Eliot Society

*Associated Organization: T.S. Eliot Society*

Chair: Edward Upton, Valparaiso University

- |         |   |                    |
|---------|---|--------------------|
| 4:00 pm | (a) <b>The Desolations of Philosophy: T.S. Eliot on the Oppressions of Idealism and Materialism</b> | <u>Third Floor</u> |
| –       | <i>Jayme Stayer, Loyola University Chicago</i>  | PD 1               |
| 5:15 pm | (b) <b>Eliot's Vanity</b>   |                    |
|         | <i>Matthew Kilbane, University of Notre Dame</i>  |                    |
|         | (c) <b>T.S. Eliot, Mysticism, and the End of Dialectic</b>  |                    |
|         | <i>Edward Upton, Valparaiso University</i>  |                    |
- 
- 

## 67. Humanity and Inhumanity in French Medical Imagery

*Permanent Section: French III, Cultural Issues*

Chair: Ian Williams Curtis, Kenyon College

- |         |  |                    |
|---------|--|--------------------|
| 4:00 pm | (a) <b>Theopolitical Therapeutics: Images of the Immune and Auto-Immune Moment</b>                                     | <u>Third Floor</u> |
| –       | <i>Matthew Senior, Oberlin College</i>   |                    |
| 5:15 pm | (b) <b>Monstrous, Mythical, or Mundane?: Interrogating the Iconography of Intersex in 19th-Century French Medicine</b> | PD 3               |
|         | <i>Laurel Iber, Oberlin College</i>  |                    |
|         | (c) <b>Normes, déviations et stéréotypes humains liés à la race dans le <i>Traité des dégénérescences</i></b>          |                    |
|         | <i>Tanya Mushinsky, Southern University Illinois–Edwardsville</i>  |                    |
- 
- 

## 68. Environmental Humanities & Planetary/Public Health: Food-Water-Energy

*Associated Organization: Association for the Study of Lit and the Environment*

Chair: Brian Deyo, Grand Valley State University

- |         |   |                    |
|---------|---|--------------------|
| 4:00 pm | (a) <b>Food-Water-Energy Criticism: The Soybean</b>                   | <u>Third Floor</u> |
| –       | <i>Brian Deyo, Grand Valley State University</i>                      |                    |
| 5:15 pm | (b) <b>Crítica de la matriz alimentación-agua-energía: el plátano</b> | PD 4               |
|         | <i>Mayra Fortes, Grand Valley State University</i>                    |                    |

Friday, November 15

(c) **Everything We Need: Curanderismo as Conceptual Lens for Chicana Environmentalisms in Ana Castillo's *So Far from God***

*Caro Register*, University of North Carolina–Chapel Hill

---

---

**69. Workshop: Countering AI's Appeal in Writing Classes**

*Pre-Organized Workshop*

Presenter: Priscilla Perkins, Roosevelt University

4:00 pm While we sometimes worry that AI could squelch students' willingness to write, we reject the premise that the humanities' decline will be written by AI. Instructors serve students best when we use "counterstories to challenge, displace, or mock pernicious narratives and beliefs" (Delgado & Stefanic 38). Our experience gives us  
– compelling counterstories that undermine AI's promise of clean  
5:15 pm academic prose, but we are also "McGyvering" AI tools to support critical acts of writing and revision.

Third Floor

PD 7

Discussion will include, how AI can help document everyday resistance in community-engaged writing courses, and how students can leverage AI tools to reflect whether what they've written accurately reflects the commitments they hold in life.

---

---

**70. Supernaturalism and the Body in Literature and Film**

Moderator: *To Be Determined*

- 4:00 pm (a) **Bodily Integrity and Disintegration in Mercè Rodoreda's "La salamandra"**  
– *Kathleen Doyle*, Rhodes College  
5:15 pm (b) **Fantastical Disorders in Haruki Murakami's Fiction**  
*Joe DeLong*, Case Western Reserve University  
(c) **Mental Illness and/as Vampirism: Martin, The Transfiguration, and Renfield's Syndrome**  
*Jamil Mustafa*, Lewis University

Fourth Floor

Room 4-A



## 71. Antiracism in Canon Formation and Pedagogy

*Permanent Section: Antiracism*

Chair: Cedric D. Burrows, Arizona State University

- 4:00 pm (a) **Antiracism Approaches to Canonical Works: Racial Melancholia as a Reading Practice**  
*Jennifer Arias Sweeney*, Northwestern University
- (b) **View from a Trauma-Informed Lens: Incorporating Trigger Warnings and Stress and Trauma Alleviation Techniques into the First-Year Composition Classroom**  
*Faye Scott*, Northern Illinois University
- 5:15 pm (c) **Transforming College Writing Classrooms: Translingualism as a Decolonial and Anti-Racist Initiative**  
*Emad Hakim*, Illinois State University
- Fourth Floor  
Room 4-B
- 
- 

## 72. The Global Western's New Frontiers

*Permanent Section: Global Cinema*

Chair: Khani Begum, Bowling Green State University

- 4:00 pm (a) **What do Netflix, Uruguay, and the Western Have in Common? The Role of Netflix in Uruguay**  
*Nayibe Bermudez-Barrios*, University of Calgary
- (b) **Black Cowboys in Space: The Reinvention of the Western in Jordan Peele's *Nope* (2022)**  
*William Ben Daniels*, Bowling Green State University
- 5:15 pm (c) **Subverting Toxic Masculinity and Empowering Female Agency in *The Power of the Dog* (2021) and *Thelma & Louise* (1991)**  
*Khani Begum*, Bowling Green State University
- Fourth Floor  
Room 4-D
- 
- 

## 73. Innovative Pedagogies: Teaching the Legacies of the Civil War Era

*Associated Organization: Civil War Caucus*

Organizer: Kathleen Diffley, University of Iowa

Chair: Jane E. Schultz, Indiana University Indianapolis

Friday, November 15

- (a) **Teaching the Medical Legacies of Slavery with Bettina Judd's *Patient***  
*Jean Franzino*, Boston College
- (b) **Teaching Black Fugitive Poetics, 1863–2024**  
*Michael Stancliff*, Arizona State University
- (c) **The “State of Possibility” in Colson Whitehead's *The Underground Railroad* and the Undergraduate Classroom**  
*Annemarie Mott Ewing*, University of Maryland–College Park
- (d) **Sherman and Other St. Louis Sepulchers**  
*Benjamin Cooper*, Lindenwood University
- (e) **Digital Approaches to Teaching the Civil War Monument**  
*Jill Spivey Caddell*, Independent Scholar  
*Clare Fisher*, University of St. Andrews

Fourth Floor  
Room 4-E

---

---

## 74. Keynote Address

### On Burning Ground: The Futures of Health in/of the Humanities

Speaker: **Andrea Charise**, University of Toronto Scarborough



5:30 pm

–

6:30 pm

Third Floor  
Williford ABC

Andrea Charise, PhD, is Associate Professor in the Department of Health and Acting Associate Vice-Principal Research and Innovation (AVPRI)–Strategic Initiatives & Partnerships, Office of the Vice-Principal Research and Innovation (OVPRI) Society, at the University of Toronto Scarborough, Canada. She is the author or editor of two recent academic books, including the *Routledge Companion to Health Humanities* (2020) and *The Aesthetics of Senescence* (SUNY Press), a finalist for the 2020 British Society for Literature and Science's Book Prize. Her research and teaching focuses on the connections between arts, health, and community wellness. She curates *The Resemblance Project*,

Friday, November 15

an award-winning intergenerational digital storytelling initiative ([www.resemblageproject.ca](http://www.resemblageproject.ca)), and is Principal Investigator of “FLOURISH: Community-Engaged Arts as a Method for Social Wellness”, an interdisciplinary research cluster dedicated to advancing creative arts engagement across the lifecourse. Beyond academia, Andrea is a studio-based [ceramics artist](#) and an end-of-life doula. ([www.andreacharise.ca](http://www.andreacharise.ca))

---

---

## 75. President’s Reception

6:30 pm

–

7:30 pm

*Celebrate with us while enjoying a range of complimentary hors d’oeuvres and (non)alcoholic drinks!*

Third Floor  
Williford ABC

# Saturday, November 16

## Book Exhibit:

8:00 am – 5:00 pm; Third Floor, Waldorf

## CV Drop-In Workshop:

10:00 am – 4:00 pm; Third Floor, PD 6

---

---

## 76. Cinematic Trauma Narratives in Contemporary Film

### *Pre-Organized Panel*

Chair: Margarete J. Landwehr, West Chester University

- |         |  |                    |
|---------|--|--------------------|
| 8:00 am | (a) <b>Coming to Terms with Personal and Historical Trauma in Petzold’s Film <i>Undine</i></b>     | <u>Third Floor</u> |
| –       | <i>Margarete J. Landwehr, West Chester University</i>  |                    |
| 9:15 am | (b) <b>Childhood Trauma in Andrei Tarkovsky’s <i>Ivan’s Childhood</i> and <i>Andrei Rublev</i></b> | PD 1               |
|         | <i>Alice J. Speh, West Chester University</i>  |                    |
|         | (c) <b>A Barbarous Form of Incest: Parker Finn’s <i>Smile</i> and <i>Suicide Contagion</i></b>     |                    |
|         | <i>Aaron Botwick, Hostos Community College</i>   |                    |

---

---

## 77. Shakespeare: Disease, Health, and the Human

### *Permanent Section: Shakespeare and Shakespearean Criticism*

Chair: Jeanette Goddard, Trine University

- |         |   |                    |
|---------|---|--------------------|
| 8:00 am | (a) <b>“To quench the coal which in his liver glows”: Humoral Imbalance in Shakespeare’s <i>The Rape of Lucrece</i></b> | <u>Third Floor</u> |
| –       | <i>Krislyn Zborne, Loyola University Chicago</i>  |                    |
| 9:15 am | (b) <b>“And let us bathe our hands in Caesar’s blood”: The Ills of the Body Politic in <i>Julius Caesar</i></b>         | PD 3               |
|         | <i>Sara Subotić, Loyola University Chicago</i>  |                    |
|         | (c) <b>The Pestilent Congregations of Shakespeare’s <i>Hamlet</i></b>   |                    |
|         | <i>Catherine Reedy, Lake Forest College</i>   |                    |

## 78. The Witness of Political Prisoners

*Permanent Section: Prison Literature*

Chair: William Andrews, North Park Theological Seminary

- |         |  |                    |
|---------|--|--------------------|
| 8:00 am | (a) <b>Bombs and Bars: Surviving War and Prison</b>                                      | <u>Third Floor</u> |
| –       | <i>Dennis R. Koehn</i> , Independent Scholar   |                    |
| 9:15 am | (b) <b>Fictions of Law: Literature of Political Imprisonment in Cuba and Puerto Rico</b> | PD 4               |
|         | <i>Gabriela Lomba Guzmán</i> , University of Chicago                                     |                    |
|         | (c) <b>Desert Rituals: Incarnation and Incarceration</b>                                 |                    |
|         | <i>Andrew J. McKenna</i> , Loyola University Chicago                                     |                    |
- 
- 

## 79. Images of African Life: Navigating Voice, Language, and Political Economy

*Permanent Section: African Literature*

Chair: Judah-Micah Lamar, Muskingum University

- |         |  |                     |
|---------|--|---------------------|
| 8:00 am | (a) <b>The Politics of Food and Nutrition in the Novels of Bessie Head</b>   | <u>Fourth Floor</u> |
| –       | <i>Londive Gamedze</i> , University of California–Berkeley   |                     |
| 9:15 am | (b) <b>Healing for the New African Woman in Mariama Ba’s <i>So Long a Letter</i></b>   | Room 4-A            |
|         | <i>Mary-Lynn Chambers</i> , Elizabeth City State University  |                     |
|         | (c) <b>Translanguaging as a Decolonial Strategy: Cultural Revitalization and Identity Formation in Achebe’s <i>Things Fall Apart</i></b> |                     |
|         | <i>Shafiq Islam</i> , Illinois State University  |                     |
- 
- 

## 80. Breaking the Silence: Narrative Approaches to Gendered Violence

*Pre-Organized Panel*

Chair: Kristin E. Pitt, University of Wisconsin–Milwaukee

- |         |  |                     |
|---------|--|---------------------|
| 8:00 am | (a) <b>Spectral Space and the Social Production of Gendered Violence in <i>Temporada de huracanes</i>, by Fernanda Melchor</b> | <u>Fourth Floor</u> |
| –       | <i>Roberto Mendoza-Farias</i> , Central Michigan University  |                     |
| 9:15 am | (b) <b>Clashing Forms of Feminist Ritual in Miriam Toew’s <i>Women Talking</i></b>   | Room 4-B            |
|         | <i>Timothy Garrison</i> , Northeastern Illinois University   |                     |

Saturday, November 16

(c) **Giving Voice to Violence in Cherie Jones' *How the One-Armed Sister Sweeps Her House***

*Kristin E. Pitt*, University of Wisconsin–Milwaukee

---

---

**81. The State, Citizenship, and Women on the Margins**

Moderator: *To Be Determined*

- |         |   |                     |
|---------|---|---------------------|
| 8:00 am | (a) <b>The Stateless Wife: Reading the Expatriation Act of 1907 and the Contours of International Citizenship</b> | <u>Fourth Floor</u> |
| –       | <i>Isabel Bethke</i> , University of Minnesota  | Room 4-C            |
| 9:15 am | (b) <b>Ghosts, AI, and the Humanities: Teaching the Works of Olivia Howard Dunbar</b>                             |                     |
|         | <i>Terence Brunk</i> , Columbia College Chicago   |                     |
- 
- 

**82. Literary Resistance to Socio-Political Oppression**

Moderator: *To Be Determined*

- |         |   |                     |
|---------|---|---------------------|
| 8:00 am | (a) <b>Mapping Tahrir: Spatial Representations and Soundtracks of Egypt's 2011 Revolution</b>   |                     |
| –       | <i>Marwa Nour</i> , Loyola University Chicago   | <u>Fourth Floor</u> |
| 9:15 am | (b) <b>Hottentot's Venus: Ecology of the Black Female Figure in Robin Coste Lewis' <i>Voyage of the Sable Venus and Other Poems</i></b> | Room 4-E            |
|         | <i>Asmita Saba</i> , Illinois State University  |                     |
|         | (c) <b>Threads of Pain: The Lingering Intergenerational Trauma in Susan Abulhawa's <i>Mornings in Jenin</i></b>                         |                     |
|         | <i>Ablam Abulaila</i> , Indiana University of Pennsylvania  |                     |
- 
- 

**83. The Literary Crosscurrents of Reconstruction**

*Associated Organization: Civil War Caucus*

Organizer: Kathleen Diffley, University of Iowa

Chair: Ian Finseth, University of North Texas

- |          |  |                     |
|----------|--|---------------------|
| 8:15 am  | (a) <b>Oliver Wendell Holmes, Rebecca Harding Davis, and the Origins of American Literary Naturalism</b> | <u>Fourth Floor</u> |
| –        | <i>John Hay</i> , University of Nevada–Las Vegas   | Room 4-D            |
| 10:00 am |  |                     |

Saturday, November 16

- (b) **Resisting the Flesh: Professional Diction as Racial Border Wall in One Surgeon’s Letters**  
*Jane E. Schultz*, Indiana University Indianapolis
- (c) **The Doctor Said, “I Do Not Like Your Corporosity, Sir!”: The Invalid Corps and Postbellum Labor Politics**  
*Marla Anzalone*, Duquesne University
- (d) **Vessels: *Leaves of Grass* and America’s Bibles**  
*Samuel Graber*, Valparaiso University
- (e) **The Politics of Slavery in Ben-Hur**  
*Andrew Donnelly*, University of Mississippi

---

---

## 84. Expanded Cinema from the Geodesic Dome to the Movie Drome

*Permanent Section: Film I*

Chair: Craig Saper, University of Maryland–Baltimore County

- |          |   |                    |
|----------|---|--------------------|
| 9:30 am  | (a) <b>Contingencies in the Archive: Exploring the Dymaxion Rhizome of Buckminster Fuller on Spaceship Earth in Southern Illinois</b> | <u>Third Floor</u> |
| –        |   | PD 1               |
| 10:45 am | <i>Laurel Jean Fredrickson</i> , Southern Illinois University–Carbondale  |                    |
|          | (b) <b>Tensegrity and the Scalar Poetics of Fluxus</b>  |                    |
|          | <i>Hannah B. Higgins</i> , University of Illinois–Chicago   |                    |
|          | (c) <b>Stan VanDerBeek’s MovieDrome and Expanded Poetics</b>  |                    |
|          | <i>Craig Saper</i> , University of Maryland–Baltimore County  |                    |

---

---

## 85. Insiders and Outsiders #1

*Permanent Section: English II, English Literature 1800–1900*

Chair: Kevin Swafford, Bradley University

- |          |  |                    |
|----------|--|--------------------|
| 9:30 am  | (a) <b>“I was there”: Pain and the Poetry of ‘I’ of Dorothy Wordsworth</b> | <u>Third Floor</u> |
| –        |  | PD 3               |
| 10:45 am | <i>Daemun Kim</i> , Indiana University–Bloomington                         |                    |
|          | (b) <b>A Tale of Three Poets</b>   |                    |
|          | <i>Jessica Williams</i> , Murray State University                          |                    |
|          | (c) <b>The Piano as Symbol in Romantic-Era Writing</b>                     |                    |
|          | <i>Jonathan Gross</i> , DePaul University                                  |                    |

## 86. Mothers in Prison

*Permanent Section: Prison Literature*

Chair: William Andrews, North Park Theological Seminary

- 9:30 am (a) “[B]eing the mother hen for all the babies who needed my love”: Outraged Mothers and Abolition Feminism in Joyce Ann Brown’s African American Confinement Literature Third Floor
- 10:45 am *Patrick Elliot Alexander*, University of Mississippi PD 4
- (b) **Maternal Exile: Letters from a French Prison during WWII**  
*Gayle A. Levy*, University of Missouri–Kansas City
- (c) **Broken Minds Behind Bars: Exploring the Psychological Toll of Incarceration in Tiffany D. Jackson’s *Allegedly***  
*Aliyah Watkins*, University of Louisiana–Lafayette
- 
- 

## 87. The Body in Literature: Representational Alternatives to Harmful Norms

*Undergraduate Research Symposium*

Moderator: *To Be Announced*

- 9:30 am (a) **Heavenly Restrictions: (Re)Presentation of Disability and Critical Trauma in Jujutsu Kaisen** Third Floor
- 10:45 am *Yufan Lu*, Kenyon College PD 5
- (b) **Bound Up: Transmasculine Health in YA Literature**  
*Wylan Boyle*, University of Wisconsin–Milwaukee
- 
- 

## 88. Navigating the Psychic Residue: Healing, Care, and Mental Health in the African Novel

*Permanent Section: African Literature*

Chair: Judah-Micah Lamar, Muskingum University

- 9:30 am (a) **Tracing Psychic Genealogies: State Centric and Transnational Bildungsroman** Fourth Floor
- 10:45 am *Michael Williamson*, Binghamton University Room 4-A
- (b) **Exploring the Dynamics of Mental Illness in Ayobami Adebayo’s *Stay with Me***  
*Sifon Moses*, Oklahoma State University



Saturday, November 16

(c) **Unveiling the Psyche: Complexities of Mental Health  
in *Purple Hibiscus***

*Aliyah Watkins*, University of Louisiana–Lafayette

---

---

**89. Philosophical Reflections on Politics and Personhood**

Moderator: *To Be Determined*

- 9:30 am (a) **Healthy Rebellion in the Body Politic: Three Early  
Modern Perspectives** Fourth Floor  
– *Sophia Feingold*, Independent Scholar Room 4-B
- 10:45 am (b) **“I am not what I am”: The Problem of a Reductivist  
Account of Personhood**  
*Sara Subotić*, Loyola University Chicago
- 
- 

**90. Lenguajes de injusticias y exclusiones en comunidades hispanohablantes**

*Permanent Section: Spanish III, Latin American Literature*

Chair: Chris T. Schulenburg, University of Wisconsin–Platteville

- 9:30 am (a) **Naming Linguistic Violence** Fourth Floor  
*Gabriela Veronelli*, Northeastern Illinois University
- (b) **Language Vulnerabilities as Settler Colonial Logics of  
Indigenous Erasure in Schools** Room 4-E
- 10:45 am *Patricia Banquedano-López*, University of California–Berkeley
- (c) **Ecos del descontento: María Luisa Bombal y La última  
niebla**  
*Edwin Murillo*, University of Tennessee–Chattanooga
- 
- 

**91. Reconstruction’s Women**

*Associated Organization: Civil War Caucus*

Organizer: Kathleen Diffley, University of Iowa

Chair: Jill Spivey Caddell, Independent Scholar

- 10:15 am (a) **Charlotte Forten’s Shadow Diary: The “Daily Record”  
of the New England Freedmen’s Aid Society** Fourth Floor  
– Room 4-D
- 11:45 am *Jennifer Putzj*, William and Mary

Saturday, November 16

- (b) **Reconstruction through Taxidermy: Martha Maxwell's Animals**  
*Elizabeth Young*, Mount Holyoke College
- (c) **Dahomey's Daughters: African American Women's Archival Agency**  
*Patricia G. Davis*, Northeastern University
- (d) **Illustrating Race, Class, and Gender in the 1880s: The Case of Sherwood Bonner and A. B. Frost**  
*Kathryn B. McKee*, University of Mississippi

---

---

## 92. Fulldome Poetics and Practices

*Permanent Section: Multimodality*

Chair: Craig Saper, University of Maryland–Baltimore County

- 11:00 am (a) **Immersive Embodied Poetics in 360° Fulldome Space**  
*Michaela French*, Fulldome Creative Network
- (b) **Matière Première/Raw Material: Narratives** Third Floor
- 12:30 pm – **Environments for Fulldome Experience** PD 1  
*Yan Breuleux*, École NAD–UQAC
- (c) **Expanded animation in the Work of Ellie Land, Maarten Isaäk de Heer, Ari Dykier, and Sumito Sakakibara**  
*Lynn Tomlinson*, Towson University
- (d) **Ec(h)o**  
*Csilla Toldy*, Independent Scholar

---

---

## 93. Insiders and Outsiders #2

*Permanent Section: English II, English Literature 1800–1900*

Chair: Kevin Swafford, Bradley University

- 11:00 am (a) **“Come in! Come in!”: Belonging and Temporal Multiplicity in Bronte's *Wuthering Heights*** Third Floor  
*Ariel Fried*, University of Missouri–Columbia
- (b) **“At heart We care nothing for laws, nothing for systems”:** **The New Woman as Outsider** PD 3  
*Mara Frances Waltz*, University of Kansas
- 12:30 pm (c) **Inside the Outside: George Eliot and Balanced Binaries**  
*Anna Schnellmann*, Lindenwood University
- (d) **Empire, Emplotment, and Opiates in *The Moonstone***  
*Katie Brandt*, University of Illinois–Chicago

---

---

## 94. Inside Knowledge: Incarcerated People on the Failures of the American Prison

*Permanent Section: Prison Literature*

Chair: William Andrews, North Park Theological Seminary

- |          |  |                    |
|----------|--|--------------------|
| 11:00 am | (a) <b>A Review of Doran Larson’s <i>Inside Knowledge</i></b><br><i>Antonio Pizarro</i> , North Park University          |                    |
| –        | (b) <b>The Language of Witness: A Reading of Doran Larson’s <i>Inside Knowledge</i></b>                                  | <u>Third Floor</u> |
| 12:30 pm | <i>Sarah Degner Riveros</i> , Metropolitan State University  | PD 4               |
|          | (c) <b>A Review of Doran Larson’s <i>Inside Knowledge</i></b><br><i>Kevin D. Strowder</i> , American Library Association |                    |
|          | (d) <b>A Response by the Author</b><br><i>Doran Larson</i> , Hamilton College  |                    |

---

---

## 95. Living, Loving and Dying in Comics and Graphic Novels

*Undergraduate Research Symposium: Pre-Organized Panel*

Chair: Keegan Lannon, University of Illinois–Chicago

- |          |  |                    |
|----------|--|--------------------|
| 11:00 am | (a) <b>Life and Death in <i>Daytripper</i></b><br><i>Mathew Rusky</i> , University of Illinois–Chicago   |                    |
| –        | (b) <b>Parenting &amp; Mental Illness</b><br><i>Makayla Ernst</i> , University of Illinois–Chicago   | <u>Third Floor</u> |
| 12:30 pm | (c) <b>Two Sides of The Same Coin: An Exploration of Familial Love and Its Effects on Self-Worth in <i>Jimmy Corrigan and Pretty Deadly</i></b><br><i>Rosh Seleena Gonzales</i> , University of Illinois–Chicago | PD 5               |
|          | (d) <b>You Are Memories</b><br><i>Luc Guerrero</i> , University of Illinois–Chicago  |                    |

---

---

## 96. Professionalizing Session: Alt Ac Careers - “Beyond a Plan B Framework”

Presenters: *Gaynyn Moore*, Santa Clara University

*Darío Sánchez-González*, Gustavus Adolphus College

- |          |   |                    |
|----------|---|--------------------|
| 11:00 am |   | <u>Third Floor</u> |
| –        | A discussion designed to offer job candidates and those considering a career change perspectives on how their academic training could transition to the non-academic or non-faculty labor | PD 7               |
| 12:15 pm |   |                    |

Saturday, November 16

market. Our workshop will consider as well current grad students who wish to target both academic and alt/ac careers from the start. This session will also provide insight for mentors who wish to support a variety of postgraduate employment goals.

---

---

## 97. Children's and Young Adult Literature and Culture #1

*Permanent Section: Children's and Young Adult Literature and Culture*

Chair: Amberyl Malkovich, Concord University

- |          |  |                     |
|----------|--|---------------------|
| 11:00 am | (a) <b>Healing Otherness?: Belonging and Well-Being in Léonora Miano's <i>Suite africaine</i></b><br><i>Jessica Tindira</i> , Eastern Illinois University                                      |                     |
| –        | (b) <b>Trauma, Health, and <i>Family Style</i></b><br><i>Lan Dong</i> , University of Illinois–Springfield   | <u>Fourth Floor</u> |
| 12:30 pm | (c) <b>“The Cane Became a Part of the Myth”: How YA Fantasy is Reimagining Disability Representation</b><br><i>Emma Fleet</i> , Columbia University  | Room 4-B            |
|          | (d) <b>“Mom, would Dad have wanted this?” Grievance and Mental Health in Middle Grade Novels with Children and Single Parents</b><br><i>Edcel Cintron-Gonzalez</i> , Illinois State University |                     |

---

---

## 98. The Mystery and Sublimity of Edgar Allan Poe

*Pre-Organized Panel*

Chair: Keli Masten, Ferris State University

- |          |   |                     |
|----------|---|---------------------|
| 11:00 am | (a) <b>“The Unusual Horror of the Thing”: Poe's Gothic Detective</b><br><i>Keli Masten</i> , Ferris State University                              |                     |
| –        | (b) <b>The Murder of Possibility: The Gothic Detective Tension of Jean Toomer's <i>Cane</i></b><br><i>Lucas McCarthy</i> , University of Michigan | <u>Fourth Floor</u> |
| 12:15 pm | (c) <b>What Happens When Poe's Gothic Aesthetics Become a Modern Spectacle?</b><br><i>Jessica Van Gilder</i> , University of Kentucky             | Room 4-C            |

Saturday, November 16

- (d) **“Mom, would Dad have wanted this?” Grievance and Mental Health in Middle Grade Novels with Children and Single Parents**

*Edcel Cintron-Gonzalez*, Illinois State University

---

---

## 99. Lenguajes, enfermedad, y otras vulnerabilidades

*Permanent Section: Spanish III, Latin American Literature*

Chair: Chris T. Schulenburg, University of Wisconsin–Platteville

- 11:00 am (a) **Unveiling the Shadows: Representations of Mental Illness in the Works of Latin American Women Writers**  
*Beatriz L. Botero*, University of Wisconsin–Madison
- (b) **Presentes vulnerables: La urgencia en el cuento “Pandemia” de Gabriela Rábago Palafox** Fourth Floor  
*Nancy Bird-Soto*, University of Wisconsin–Milwaukee Room 4-E
- 12:30 pm (c) **Trauma y exilio: la memoria del narcotráfico en *El ruido de las cosas al caer***  
*Nelly Zamora-Breckenridge*, Valparaiso University
- (d) **En bocas cerradas: El canibalismo disfrazado en *Cadáver exquisito* (2017)**  
*Chris T. Schulenburg*, University of Wisconsin–Platteville
- 
- 

## 100. Film in the Classroom

*Permanent Section: Film II*

Chair: Judit Palencia Gutierrez, California State University–Fullerton

- 12:45 pm (a) **Trascendiendo fronteras: Reflexiones sobre el colonialismo y la identidad en el cine contemporáneo**  
*José Manuel Medrano*, St. Bonaventure University
- (b) **Film as Sign Manipulation: A Collective Philosophical Analysis of the Act of Film Production** Third Floor  
*Elliott Koch*, University of California–Riverside PD 1
- 2:15 pm (c) **Entre la realidad y la representación: el debate sobre *Ixcanul* (2015) y la minorización de la mujer**  
*Manuel A. Sánchez Cabrera*, University of NC–Chapel Hill
- (d) **The Classroom as Self-Discovery: Teaching “Jews in American Film” Amidst Shifting Cultural Contexts**  
*Joseph Ozias*, University of Cincinnati
- 
-

## 101. Contemporary Discourses of Well-Being

Moderator: *To Be Determined*

- 12:45 pm (a) **Transpersonal Psychology and Practical Spirituality: Furthering Human Flourishing Across the Positive Humanities**  
*John M. Andrick*, University of Illinois–Urbana-Champaign
- (b) **Dropping Anchor: Fostering Well-Being in Children through Short Stories** Third Floor  
*Rolii Agrawal*, Jagran Lakecity University PD 3
- 2:15 pm (c) **Self-Help Happiness: Eudaimonia in the Age of Quick-Fix Culture**  
*Ren Maloney*, Indiana University
- (d) **Capitalism’s Self-Care Corruption: How Wellbeing Rhetoric Sustains our False Faith**  
*Ryan Vojtisek*, University of Wisconsin–Milwaukee
- 
- 

## 102. Professionalizing Session: Online Teaching

Presenters: *Joe Keener*, Indiana University Kokomo

*Eric Wistrom*, United States Naval Academy

- 12:45 pm This workshop will discuss online teaching, driven mostly by Third Floor  
– examples from Canvas. Topics will include strategies for effective and PD 7  
2:00 pm engaging asynchronous online, synchronous online, and blended learning models. Successes and challenges will be addressed, and attendants are encouraged to ask questions or make comments throughout.
- 
- 

## 103. Practice, Eugenics, and Parasites: The Medical Profession in African American Literature

Permanent Section: *African American Literature*

Chair: Noemí Fernández Labarga, University of Notre Dame

- (a) **Novel Doctors: The Black Medical Professional in Fiction**  
*Patrick S. Allen*, Elizabethtown College

Saturday, November 16

- 12:45 pm (b) **Eugenic Ideology, Progressive Epistemology, and W.E.B. Du Bois's Poetics of Reform** Fourth Floor  
– Room 4-A  
2:00 pm *Daniel Fulton Cheung*, Loyola University Chicago  
(c) **Parasitism, Free Indirect Style, and Mental Colonization: Teju Cole's *Open City***  
*Alp Eren Pirlı*, Indiana University Bloomington
- 
- 

## 104. Children's and Young Adult Literature and Culture #2

*Permanent Section: Children's and Young Adult Literature and Culture*

Chair: *Amberly Malkovich*, Concord University

- 12:45 pm (a) **Health as a Journey in Native American Children's Literature** Fourth Floor  
– *Genevieve Ford*, Utah State University-College of Eastern Utah Room 4-B  
2:15 pm (b) **Banning Children's Books for the Health of Society?**  
*Lianna Farber*, University of Minnesota  
(c) **Reflections of the Mind: Considering the Representation of Mental Health in Young Adult Literature**  
*Amberly Malkovich*, Concord University  
(d) **He Cried Nevermore: Poe and Gothic Expression**  
*George Williams*, Concord University
- 
- 

## 105. Social Critique in American Periodicals

Moderator: *To Be Determined*

- 12:45 pm (a) **Didactic Causality and Charles Brockden Brown's "The Man at Home"** Fourth Floor  
– *David Jakalski*, Oakton College Room 4-C  
2:00 pm (b) **Quarantine and Inoculation: Verity in Boston's 1721 "Paper-War"**  
*Kristen Hartman*, Wenzhou Kean University  
(c) **Power, Media, and "Fake News?": A Tale of Twin City Rivalry Through the Lens of Two Newspapers**  
*Cari Coleman Godin*, University of Maryland–Baltimore County
- 
-

---

---

## 106. Crossing Boundaries: Narrative Juxtapositions in Film and Literature

*Pre-Organized Panel*

Chair: Michael Modarelli, Walsh University

- |          |  |                     |
|----------|--|---------------------|
| 12:45 pm | (a) <b>Postcolonial and the Gothic in Nadine Gordimer's <i>The Conservationist</i> and Jane Campion's <i>Sweetie</i></b> | <u>Fourth Floor</u> |
| —        | <i>Michael Modarelli, Walsh University</i>   |                     |
| 2:00 pm  | (b) <b>Fantastic Decolonizations of the Border: <i>Frida</i> and <i>Signs Preceding the End of the World</i></b>         | Room 4-E            |
|          | <i>Stephanie R. Gates, Wheaton College</i>   |                     |
|          | (c) <b>True Colors: Intersectionality and Code-Switching in <i>The Bluest Eye</i></b>                                    |                     |
|          | <i>Nicholas P. Markellos, Rutgers University</i>   |                     |

---

---

## 107. Indigenous Thought in the Long Reconstruction

*Associated Organization: Civil War Caucus*

Organizer: Kathleen Diffley, University of Iowa

Chair: Timothy Sweet, West Virginia University

- |         |   |                     |
|---------|---|---------------------|
| 2:15 pm | (a) <b>Colonel Beaulieu's War: Making the White Earth Nation, 1862–1868</b>               | <u>Fourth Floor</u> |
| —       | <i>Adam Spry, University of Michigan</i>  |                     |
| 4:00 pm | (b) <b>Ely Parker in War and Peace</b>  | Room 4-E            |
|         | <i>Sandra M. Gustafson, University of Notre Dame</i>                                      |                     |
|         | (c) <b>Milton and Modernity in Simon Pokagon's <i>The Red Man's Rebuke / Greeting</i></b> |                     |
|         | <i>Timothy Donahue, Oakland University</i>  |                     |

---

---

## 108. Teaching Literature Through Reading Bridges

*Pre-Organized Panel*

Chair: Timothy Hendrickson, Trinity Christian College

- |         |  |                    |
|---------|--|--------------------|
| 2:30 pm | (a) <b>The Pedagogy of Bridging: The Poems of Langston Hughes and <i>Brown Girl Dreaming</i> by Jacqueline Woodson</b> | <u>Third Floor</u> |
| —       | <i>Kristin Bolkema, Trinity Christian College</i>  |                    |
| 3:45 pm | (b) <b>The Pedagogy of Bridging: Faust Stories in Discussion</b>   | PD 1               |
|         | <i>Bill Boerman-Cornell, Trinity Christian College</i>   |                    |



Saturday, November 16

(c) **Approaching Difference Through Bridging: Portrayals of Disability in *Of Mice and Men* and *The Bridge Home***

*Christine Scholma*, Trinity Christian College

---

---

**109. Novelizing Anthropomorphic Animals & Animality**

Moderator: *To Be Determined*

- |         |  |                    |
|---------|--|--------------------|
| 2:30 pm | (a) <b>The Esibanag Manifesto–Radical Raccoons in <i>Noopiming</i> and the Agential Resistance of Pests</b>      | <u>Third Floor</u> |
| –       | <i>Fatima Hasnain</i> , Loyola University Chicago  | PD 3               |
| 3:45 pm | (b) <b>Mapping Animal Communities in Woolf</b>   |                    |
|         | <i>Stewart Cole</i> , University of Wisconsin–Oshkosh<br><i>Sarah Schaefer</i> , University of Wisconsin–Oshkosh |                    |
- 
- 

**110. Prison Writing Programs**

*Permanent Section: Prison Literature*

Chair: William Andrews, North Park Theological Seminary

- |         |  |                    |
|---------|--|--------------------|
| 2:30 pm | (a) <b>“Writing from both Sides of the Moon”: Works by the Writers’ Collective “WRIT112” at Stateville Correctional Center</b> | <u>Third Floor</u> |
| –       | <i>Melissa Pavlik</i> , North Park University  | PD 4               |
| 3:45 pm | (b) <b>Reorganizing, Expanding and Maintaining Writing Programs Inside and Outside the Penal System</b>                        |                    |
|         | <i>William Lederer</i> , Independent Scholar   |                    |
- 
- 

**111. (Mis)Representations in Shakespeare: Disability and the Vice Archetype**

*Undergraduate Research Symposium*

Moderator: *To Be Announced*

- |         |   |                    |
|---------|---|--------------------|
| 2:30 pm | (a) <b>Disability and Technology: Creating Inclusive Theatre Spaces in <i>Richard III</i></b> | <u>Third Floor</u> |
| –       | <i>Sophie Jensen</i> , Northern Arizona University  | PD 5               |
| 3:45 pm | (b) <b>Hal as Vice Figure and his Life through the Lens of the Morality Play</b>              |                    |
|         | <i>Kait Harland</i> , Trinity Christian College   |                    |
- 
-

## 112. Trauma and Embodiment in African American Literature

*Permanent Section: African American Literature*

Chair: Noemí Fernández Labarga, University of Notre Dame

- |         |  |                     |
|---------|--|---------------------|
| 2:30 pm | (a) <b>“There was something else . . . a quality within herself”:<br/>The Trauma of Neglect in Nella Larsen’s <i>Quicksand</i></b> | <u>Fourth Floor</u> |
| –       | <i>Faye Scott</i> , Northern Illinois University   |                     |
| 3:45 pm | (b) <b>Healing Trauma through Community in Three Novels<br/>by Rivers Solomon</b>  | Room 4-A            |
|         | <i>Noemí Fernández Labarga</i> , University of Notre Dame  |                     |
|         | (c) <b>Considering Health as a Permanent Liminality in <i>Sing,<br/>Unburied, Sing</i></b>   |                     |
|         | <i>Natalie Steenbergh</i> , Rochester Christian University   |                     |
- 
- 

## 113. Disease, Health, and Identity in Irish Literature

*Permanent Section: Irish Studies*

Chair: Desmond Harding, Central Michigan University

- |         |  |                     |
|---------|--|---------------------|
| 2:30 pm | (a) <b><i>Ulysses</i>’ Silences</b>  | <u>Fourth Floor</u> |
| –       | <i>Ery Shin</i> , University of Southern Mississippi                       | Room 4-B            |
| 3:45 pm | (b) <b>The Enigma of Grief and Survival in James Joyce’s<br/>Dubliners</b> |                     |
|         | <i>Desmond Harding</i> , Central Michigan University                       |                     |
- 
- 

## 114. Spanish I: Peninsular Literature before 1700 #1

*Permanent Section: Spanish I, Peninsular Literature before 1700*

Chair: John Paul Giblin, University of Kentucky

- |         |   |                     |
|---------|---|---------------------|
| 2:30 pm | (a) <b>Food, Farce, and Fellowship in Calderón de la Barca’s<br/>“Mojiganga de los guisados”</b>                              | <u>Fourth Floor</u> |
| –       | <i>John McCann</i> , University of Wisconsin–Milwaukee  | Room 4-E            |
| 3:45 pm | (b) <b>Ecos horacianos en <i>Los mirones de la corte</i></b>  |                     |
|         | <i>José Rico-Ferrer</i> , Wayne State University  |                     |
|         | (c) <b>“What’s a letter or two between friends?”: Contagion,<br/>violence, and comedic closure in <i>La vida es sueño</i></b> |                     |
|         | <i>Jeanette Goddard</i> , Trine University  |                     |
- 
-

## 115. German Literature and Film

*Permanent Section: German Literature and Film*

Chair: Bethany A. Morgan, Iowa State University

- |         |  |                                 |
|---------|--|---------------------------------|
| 2:30 pm | (a) <b>Art and Desire in Evelyn Schlag's <i>Die göttliche Ordnung der Begierde</i></b>                 | <u>Fourth Floor</u><br>Room 4-E |
| –       | <i>Thyra E. Knapp</i> , University of North Dakota   |                                 |
| 3:45 pm | (b) <b>Women Mystics in Films by Margarethe von Trotta</b>   |                                 |
|         | <i>Bethany A. Morgan</i> , Iowa State University   |                                 |
|         | (c) <b>The Function of Horror in Hoffmann's Struwwelpeter and Gaiman's Coraline. A Reconsideration</b> |                                 |
|         | <i>Madelon Köhler-Busch</i> , University of Wisconsin–Platteville                                      |                                 |
- 
- 

## 116. Female Subjects as Objects and Agents in Early Modern Literature

Moderator: *To Be Determined*

- |         |   |                            |
|---------|---|----------------------------|
| 4:00 pm | (a) <b>Female Bodies in <i>Cymbeline</i>: Possession, Poison, Potion</b>                              | <u>Third Floor</u><br>PD 1 |
| –       | <i>Anne Mcilbaney</i> , Webster University  |                            |
|         | (b) <b>To the Virtuous Reader: Early Modern Scholarship and the Petrarchanizing of Aemelia Lanyer</b> |                            |
| 5:15 pm | <i>Maria Capecchi</i> , Elmhurst University   |                            |
|         | (c) <b>Writing Their Way In: Bearing Children and Writing Books in 17th Century England</b>           |                            |
|         | <i>Laura Anne Carroll-Adler</i> , University of Southern California                                   |                            |
- 
- 

## 117. Literary Arts in Prison: Perspectives from Inside

*Permanent Section: Prison Literature*

Chair: William Andrews, North Park Theological Seminary

- |         |  |                            |
|---------|--|----------------------------|
| 4:00 pm | (a) <b>Literary Arts in Prison: Perspectives from Inside</b> | <u>Third Floor</u><br>PD 3 |
| –       | <i>Leigh Sugar</i> , Independent Scholar                     |                            |
| 5:15 pm | (b) <b>Literary Arts in Prison: Perspectives from Inside</b> |                            |
|         | <i>Tara Betts</i> , DePaul University                        |                            |
|         | (c) <b>Literary Arts in Prison: Perspectives from Inside</b> |                            |
|         | <i>Victoria Alvarez</i> , Prison + Neighborhood Arts Program |                            |
- 
-

## 118. Joy, Mental Illness, and Personhood in African American Literature

*Permanent Section: African American Literature*

Chair: Noemí Fernández Labarga, University of Notre Dame

- 4:00 pm (a) **Thinking of Character through Black Joy in Ernest Gaines' "Just Like a Tree"** Fourth Floor  
*Alice Wilson*, University of Louisiana–Lafayette
- 
- 5:15 pm (b) **Depression as a Problem of Writing: *Willow Weep For Me's* Black Feminist Reimagination** Room 4-A  
*Curtis Browne*, Brown University
- (c) **Redrawing the Human: Blackness and Animality in Kaitlyn Greenidge's *We Love You, Charlie Freeman***  
*Kara Kendall-Morwick*, Washburn University
- 
- 

## 119. New Pedagogical Approaches to Reproductive Justice

Moderator: *To Be Determined*

- 4:00 pm (a) **Pedagogical Interventions in Reproductive Justice: Connecting Healthcare and Education** Fourth Floor  
*Amber Chavez*, University of Wisconsin–Milwaukee Room 4-B
- 
- 5:15 pm (b) **Narratives around Sex-Ed: From Opt-Out/Opt-In and "Good vs. Bad" Choices to a Curriculum of Care**  
*Rachel La Due*, University of Wisconsin–Milwaukee
- 
- 

## 120. Class and Identity in Twenty-First-Century Fiction and Film

Moderator: *To Be Determined*

- 4:00 pm (a) **Personas and Performances: Narrative Strategy and Affective Alliances in Virginia Woolf's *Three Guineas*** Fourth Floor  
*Patrick Henry*, University of North Dakota
- 
- 5:15 pm (b) **Addiction, Recovery, and the Psychological Burdens of Class in Denis Johnson's Short Fiction** Room 4-C  
*David Buehrer*, Valdosta State University
- (c) **Poverty as a Disease in Layla Martínez's *Carcoma* (2021)**  
*Olga Bezhanova*, Southern Illinois University–Edwardsville
- 
-

## 121. New & Noteworthy: From a Wide Angle

*Associated Organization: Civil War Caucus*

Organizer: Kathleen Diffley, University of Iowa

Chair: Kathleen Diffley, University of Iowa

- |         |  |                                 |
|---------|--|---------------------------------|
| 4:00 pm | (a) <b>Author of <i>Faith in Exposure: Privacy and Secularism in the Nineteenth-Century United States</i></b><br><i>Justine S. Murison</i> , University of Illinois–Urbana-Champaign | <u>Fourth Floor</u><br>Room 4-D |
| –       | (b) <b>Author of <i>American Tyrannies in the Long Age of Napoleon</i></b><br><i>Elizabeth Duquette</i> , Gettysburg College   |                                 |
| 5:15 pm | (c) <b>Author of <i>Extinction and the Human: Four American Encounters</i></b><br><i>Timothy Sweet</i> , West Virginia University  |                                 |
|         | (d) <b>Author of <i>Haunted by the Civil War: Cultural Testimony in the Nineteenth-Century United States</i></b><br><i>Shirley Samuels</i> , Cornell University                      |                                 |
- 
- 

## 122. Spanish I: Peninsular Literature before 1700 #2

*Permanent Section: Spanish I, Peninsular Literature before 1700*

Chair: John Paul Giblin, University of Kentucky

- |         |  |                                 |
|---------|--|---------------------------------|
| 4:00 pm | (a) <b>Bleeding Women: Menstruation, Bloodletting Practice, and Menopause in Early Modern Spain</b><br><i>Jenny Jihyun Jeong</i> , University of Wisconsin–Madison | <u>Fourth Floor</u><br>Room 4-E |
| –       | (b) <b>El urdir sociohistórico de dos <i>vidas</i> barrocas</b><br><i>Denise Oyuki Castillo</i> , University of Wisconsin–Madison                                  |                                 |
| 5:15 pm | (c) <b>Picaresque Families: (Un)reliable Judgments in <i>Lazarillo de Manzanares</i></b><br><i>John Paul Giblin</i> , University of Kentucky                       |                                 |
- 
-